

FINAL PROGRAM

40th
anniversary

STFM Conference on
Medical Student Education

Get Inspired. Get motivated. Get educated. Get connected.



January 30-February 2, 2014
Gaylord Opryland Hotel & Resort • Nashville, TN



table of contents

Overall Conference Schedule – 4

Preconference Workshops – 4

Session Formats – 8

Daily Schedules

Friday, January 30 – 10

Saturday, February 1 – 21

Sunday, February 2 – 28

Posters – 29-32

Special Topic Breakfast – 18-20

STFM Group Meetings – 10 and 22

General Conference Information – 33

Society of Student-Run Free Clinics Conference – 35

Conference Partners and Supporters – 34

Hotel Meeting Space Map – back cover

Search educational sessions
and view abstracts
at www.stfm.org/mobile
or by scanning this QR code.



Join the conversation on Twitter: #MSE14

Thursday, January 30

- 7 am–7 pm** **Conference Registration**
Room: Tennessee Lobby
- 7 am–5:30 pm** **2014 STFM Medical Student Educators Development Institute (MSEDI)**
(pre-registration required)
Room: Ryman Studio F-G
- 1–5 pm** Preconference Workshops:
- PR1: Engaging Today’s Medical Student**
Juliann Binienda, PhD, Margit Chadwell, MD, Wayne State University; Kathryn Conniff, MD, Mozella Williams, MD, University of Maryland; Peggy Cyr, MD, Maine Medical Center South, Portland, ME; Miriam Hoffman, MD, Boston University Medical Center; Amanda Kost, MD, University of Washington; Suzanne Minor, MD, Florida International University, Miami, FL; Jacob Prunuske, MD, MSPH, University of Minnesota-Duluth; Vincent WinklerPrins, MD, Georgetown University, Washington, DC
Room: Ryman Studio L
- PR2: FMIG Faculty Advisor Summit**
Co-Conveners: Stan Kozakowski, MD, director, Medical Education Division; Ashley Bentley, MBA, student interest strategist; Sam Carlson, student interest project specialist, AAFP FMIG Network, American Academy of Family Physicians
Room: Ryman Studio P-R
- 6–6:30 pm** **Orientation for First-Time Attendees and New Members**
Aaron Michelfelder, MD, conference chair and Joel Heidelbaugh, MD, conference cochair
Room: Tennessee Ballroom A-B
- 6:30–7:30 pm** **Welcoming and Networking Reception**
Room: Tennessee Ballroom A-B

Friday, January 31

- 6:30–7 am** **Orientation for First-Time Attendees and New Members:** If you’re not able to join us on Thursday evening, stop by and learn more about the 2014 conference.
Aaron Michelfelder, MD, conference chair and Joel Heidelbaugh, MD, conference cochair
Room: Ryman Studio B-C
- 7 am–6 pm** **Conference Registration**
Room: Tennessee Lobby
- 7–8 am** **STFM Groups Meetings and Open Table Discussions with Breakfast**
See page: 10
- 8:15–9:45 am** **Conference Welcome with Announcements and Greetings**
Aaron Michelfelder, MD, conference chair
- Opening General Session: Inspiration or Expiration?**
Elizabeth Garrett, MD, MSPH, University of Missouri-Columbia
Tennessee Ballroom C-E

9:45–10:15 am

Refreshment Break with Conference Partners and Opening of Poster Hall

Room: Tennessee Lobby

10:30 am–Noon

Concurrent Educational Sessions

12:15–1:30 pm

Networking and Student Scholars Recognition Luncheon

Room: Tennessee Ballroom C-E

To learn more about the 2014 Scholars, please read their essays & statements at the Awards Table near the STFM Conference Registration Desk.

*Benjamin Adler, University of Massachusetts Medical School
Nominated by: Wendy Biggs, MD*

*Marina Cervantes, Univ of Cincinnati, Dept of Family and Community
Nominated by: Barbara Tobias, MD*

*Sharon Chacko, University of South Florida Morsani College of Medicine
Nominated by: Kira Zwygart, MD*

*Karl Dietrich, Geisel School of Medicine at Dartmouth
Nominated by: Cathleen Morrow, MD*

*Peter Meyers, University of Minnesota Medical School
Nominated by: David Power, MD, MPH*

*Amanda Miller, KU School of Medicine – Wichita
Nominated by: Scott Moser, MD*

*Jessica Portillo, Pritzker School of Medicine, Univ of Chicago
Nominated by: Mari Egan, MD, MHPE*

*Maggie Reinsvold, University of Colorado School of Medicine
Nominated by: David L. Gaspar, MD*

*Hannah Rosenblum, Albert Einstein College
Nominated by: William Jordan, MD, MPH*

*Ivana Simpson, Florida State University College of Medicine
Nominated by: Joederecka Brown, MD*

*Tiffany Ho, John Hopkins University (Target School)
Nominated by: Jun Mao, MD*

Thanks to the AAFP for their support of the 2014 Target School Scholarship, and to all of YOU who donated at the 2013 conference or on your conference registration. Because of your contributions, the 2014 Student Scholarship Program has doubled in size this year. Please continue to support this program through the STFM Foundation (see our Foundation staff at their table near the registration desk).

1:45–3:15 pm

Concurrent Educational Sessions

3:15–3:30 pm

Refreshment Break with Conference Partners and Poster Presentations

Room: Tennessee Lobby

Friday, January 31 (cont.)

3:30–5:30 pm **Concurrent Educational Sessions**

7 pm **Dine-Around Opryland!**
 Sign-up sheets are available on the message board at the Conference Registration Desk.

Saturday, February 1

6:30–7 am **Annual Fun Run & Walk**
 Would you like to have some fun and support the 2015 STFM Student Scholar's Program?
 Consider these options:

1. Run or walk and encourage your colleagues to run with you.
 The conference chair and cochair will each donate \$1 per participant.
2. Sponsor a runner or walker by making a lump sum donation.
3. Run or walk, have the chairs donate \$1 on your behalf, and make your own lump sum donation.

Fun Run/Walk route maps and pledge cards are available at the Conference Registration Desk. Donations or pledges are not required for participation. T-shirts will be available to the first 100 walkers/runners completing the event.

7 am–5:15 pm **Conference Registration**
 Room: Tennessee Lobby

8 am–5 pm **Concurrent Conference: 2014 Student-Run Free Clinic Conference**
 Additional fee; see page 35

7:30–8:30 am **Special Topic Breakfasts**
 See pages 18-22 for a complete list.

8:30–9 am **Saturday Morning Kick-Off: The Future Family Physician**
STFM President John Saultz, MD

Student Scholars and Poster Recognition
 Room: Tennessee Ballroom C-E

9–9:45 am **Refreshment Break with Conference Partners and Poster Presentations**
 (Last chance to visit posters!)
 Room: Tennessee Lobby

10–11:30 am **Concurrent Educational Sessions**

11:30 am–1 pm **Open Lunch with Optional STFM Group Meetings (Lunch on your own)**
 See meetings on page 22

1–2:30 pm **Concurrent Educational Sessions**

2:30–3 pm **Refreshment Break with Conference Partners**
 Room: Tennessee Foyer

3–5 pm **Concurrent Educational Sessions**

Optional Evening Events: **STFM Night at the Grand Ol' Opry or STFM Bus to Downtown Nashville**
 Preregistration was required for both activities. No additional tickets are available.

STFM Night At The Grand Ol' Opry

A special “once in a lifetime” group activity at the show that made country music famous! **Ticket purchase was required in advance.**

The Grand Ol' Opry is located directly behind the Opryland Resort (3-4 block walk).

Show Time: 7–10 pm (please plan to arrive and be seated by 6:45 pm)

The Opryland resort does provide transportation if needed. For more information, contact the resort concierge.

STFM Bus Trip to Downtown Nashville

Join friends on a roundtrip bus trip to colorful and historic downtown Nashville!

Reservations were required in advance.

Loading & Departure Times/Locations:

6:30 pm from the Opryland Resort (Magnolia Lobby; please arrive to board by 6:15 pm.) The bus will depart promptly at 6:30 pm.

11 pm from downtown Nashville (Location TBD by bus company; drop-off & pick-up at same location; please arrive to board by 10:45 pm).

The bus will depart downtown promptly at 11 pm. Travel time is approximately 20-minutes.

Sunday, February 2

7:30–10 am

Conference Registration

Room: Tennessee Lobby

7:30–8:30 am

STFM and SSRFC Networking Breakfast

STFM Group Meeting Breakfasts

Room: Tennessee Ballroom C-E

8:45-9:45 am

Closing General Session: Family Physicians, Volunteering, and Free Clinics: No Such Thing as a Free Lunch

Bonzo Reddick, MD, MPH, New Hanover Regional Medical Center, Wilmington, NC

Room: Tennessee Ballroom C-E

9:45 am

Conference Adjourns

STFM and Conference Presenters Want Your Feedback!

Please be sure to evaluate each of the educational sessions that you attend at:

stfm.org/sessionevaluation

Also, be sure to complete the Conference Overall Evaluation before you leave the conference, or on your way home, at:

stfm.org/evaluation

Session Formats

The Conference on Medical Student Education offers a variety of session formats to satisfy differing needs. Here is a brief overview of the sessions available for your participation:

Workshops: 2-hour task-oriented, small-group educational sessions

Seminars: 90-minute didactic presentations with audience discussion

Symposia: 90-minute sessions provide on collaborative work from multiple institutions or departments with a moderator organizing a brief presentation to stimulate focused discussion by participants.

Lecture-Discussions: 45-minute didactic presentations with discussion; Two lectures are paired and offered consecutively in a 90-minute session.

PEER In-Progress and Completed Projects: 15-20 minute Professional Education Experience Review (PEER) sessions

Hot Topic Sessions: 45-90 minute sessions with topics and presenters selected based on the current need of the discipline

Poster Presentations: Visual presentations with an informal information exchange; attendees can peruse the posters and speak with the presenters. 90-minutes total, during three refreshment breaks

Special Topic Breakfasts: 60-minute, informal presentations to share experiences, ideas, problems, or solutions; leaders briefly present material and facilitate discussion. Limit 10 participants per table.

Common Interest Breakfasts: 60-minute, informal discussions by STFM Groups to share experiences and ideas about common topics in family medicine education. Group chairs facilitate discussion. Limit 10 participants per table.

NOTE: Pay close attention to room names. There are both Studios and Ballrooms with the Ryman name.

Use the STFM Mobile Site to Navigate the Conference

stfm.org/mobile

- Learn about last-minute changes to sessions
- Review the daily schedule-at-a-glance
- Search for sessions by speaker, by topic, by day, or by time
- Read the full abstracts
- Complete your session evaluations
- Visit the partner websites

Free wireless access in the session rooms. Select the **oprylandconvention** wireless network, then: Username: **medicine** Password: **stfm1967**



Mobile site menu



Mobile site session search



Mobile site evaluation

STFM and Conference Presenters Want Your Feedback!

Please be sure to evaluate each of the educational sessions that you attend at:

stfm.org/sessionevaluation

Also, be sure to complete the Conference Overall Evaluation before you leave the conference, or on your way home, at:

stfm.org/evaluation

Educational Track for Coordinators

This year's conference is incorporating a special educational track for coordinators. The following presentations have been identified by our STFM Group on Medical Student Education Coordinators for particular interest to our coordinator attendees: L7B; L13A; L13B; SY4; B17; B23; B26. These sessions are noted with [COORD] following the presentation title.

Conference Faculty Disclosure and Conflict of Interest Policy:

The STFM conference planning committee has selected and/or invited all faculty appearing in this program, including general session speakers. According to STFM policy, all relationships between planning members, speakers, and proprietary entities that may have a direct interest in the subject matter of their presentation(s) will be disclosed.

Disclosure Statement:

STFM requires every presenter, author, or individual involved in content development, whether lead or secondary, to fully disclose any significant financial interest or other relationship with the commercial supporter(s) of this educational activity or with the manufacturer(s) of any commercial product(s) and/or providers of commercial services discussed in this educational activity including 1-year prior to and/or 1-year following conference presentation(s). Disclosure documents are reviewed for potential conflicts of interest and, if identified, they are resolved prior to confirmation of participation. Only these participants who have no conflict of interest or who agree to an identified resolution process prior to their participation were involved in this CME activity.

Activity Staff Disclosures:

The planners, reviewers, editors, staff, CME committee, or other members who control content have no relevant financial relationships to disclose.

Faculty Disclosures:

The following presenters have completed a Faculty Disclosure and Conflict of Interest Form, in accordance with the ACCME guidelines for accreditation, and have disclosed conflicts of interest. These disclosures have been reviewed by the conference steering committee, and have been determined to not be in conflict of the content of the presentation. These presenters have been notified regarding this outcome, and each presenter is required to disclose these conflicts at the beginning of their CME presentation.

Presenter Name: Kathryn Horn, MD
Session #: L5A

Submission Title: The Dean's Letter: Inspiring Faculty and Students to Contribute in a Meaningful Fashion

Disclosure Data Provided By Presenter
Presenter Name: Emily Hajjar, PharmD
Session #: L30A
Submission Title: Leading an Interprofessional Geriatric Clinical Skills Fair: A "Train the Trainer" Session

Presenter Name: Tom Vansaghi, PhD
Session #: L24B
Submission Title: Teaching Physician: The Resource for Supporting Faculty Development of Community-Based Preceptors

Presenter Name: Peter Lewis, MD
Session #: PM1
Submission Title: Promoting Professionalism: An Interdisciplinary Longitudinal Curriculum in Reflective Practice

Presenter Name: Katherine Wagner, MD
Session #: L18B
Submission Title: Flipping the Classroom: Using Novel Teaching Tools to Maximize Learning Opportunities Within a Transition Clerkship

Presenter Name: William Huang, MD
Session #: PG3
Submission Title: Student Self-Assessment of Strengths and Needed Improvements at the Midpoint of a Family Medicine Clerkship

Presenter Name: Karen Halpert, MD
Session #: PH1
Submission Title: Teaching Residents to Give Quality Feedback

Presenter Name: Howard Sussman, MD, FAAFP
Session #: PB2
Submission Title: The Good, the Bad, and the Ugly: Lessons From the Transformation to a Longitudinal Clerkship

Presenter Name: Katherine Wagner, MD
Session #: PI4
Submission Title: Putting the "Family" in Family Medicine: Using a Standardized Patient Family to Teach Health Promotion

Presenter Name: Andrea Wendling, MD
Session #: L38A
Submission Title: If You Build It, They Will Come: Program Development In Distributive Predoctoral Models of Education

Presenter Name: David Keegan, MD, FCFP
Session #: L38B
Submission Title: How to Measure the Learning Environment

Presenter Name: Paul Lecat, MD
Session #: S7
Submission Title: Can We Do a Better Job of Teaching Auscultation Skills, Using Hybrid Simulation?

Presenter Name: Andrea Wendling, MD
Session #: PK1
Submission Title: R U 4 PC: Texting and Feedback on Primary Care During Medical School

Presenter Name: Mario Cornacchione, DO
Session #: PD2
Submission Title: Addiction: An Intervention to Influence Medical Students' Attitudes and Response to Substance Abuse Within Professionals

Presenter Name: Tom Vansaghi, PhD
Session #: S1
Submission Title: Power of Politics and Change

Presenter Name: David Keegan, MD
CCFP(EM) FCFP
Session #: PH5
Submission Title: Determining the Practice Competency Objectives of SHARC-FM (the Shared Canadian Curriculum in Family Medicine)

Presenter Name: David Keegan, MD
CCFP(EM) FCFP
Session #: PA5
Submission Title: Making Change Happen: Increasing the Percentage of Students Choosing Family Medicine as a Career

Presenter Name: David Keegan, MD
CCFP(EM) FCFP
Session #: PP2
Submission Title: A Family Medicine/ Medical Education Elective for Medical Students

Presenter Name: David Keegan, MD
CCFP(EM) FCFP
Session #: HT2
Submission Title: How to Increase Student Interest in Family Medicine: The Canadian Success Story

All other presenters listed in the following educational activities (except Poster and Breakfast presentations, which have not been reviewed/ approved for CME) have completed a Faculty Disclosure and Conflict of Interest Form, in accordance with the ACCME guidelines for accreditation, and have reported they have no relevant financial relationships to disclose.

7–8 am

Conference Breakfast

Room: Tennessee Ballroom C-E

NOTE: Pay close attention to room names. There are both Studios and Ballrooms with the Ryman name.

STFM Groups Meetings and Open Table Discussions With Breakfast

All conference attendees are welcome to participate in these meetings to learn more about STFM activities and how to get involved.

Group on Medical Student Education: Business Meeting

Room: Ryman Studios D-E

Group on Medical Student Educator Academic Coordinators

Room: Ryman Studio L

Group on the Family Medicine Pipeline

Room: Tennessee Ballroom

Special Presentation for Students & Residents: My Life And Budget As a Resident: A Panel Discussion

Melissa Robinson, Esther Johnston, MD, MPH, STFM Education Committee

This informal breakfast discussion, targeted at student attendees, will feature a panel of residents who will describe their life and budget as residents.

Room: Ryman Studio M

Health Literacy Training for Medical Students

Room: Tennessee Ballroom

8:15–9:45 am

Opening General Session: Inspiration or Expiration?

Room: Tennessee Ballroom C-E



Elizabeth Garrett, MD, MSPH, University of Missouri-Columbia

Moderator: Aaron Michelfelder, MD, conference chair

As we celebrate the 40th anniversary of STFM's Medical Student Education Conference, it is appropriate to reflect on ourselves and our work with our learners. What is the role of inspiration? Is it critical to our specialty's continued existence, especially in the setting of predicted great shortages in primary care physicians? Who does it best? Who needs it most? Can we simply choose to inspire or mentor, or is it really in the control of others? If your role as a family medicine educator working with students were a country tune, what would the title be?

By the end of the plenary, the listener will have:

1. Reflected on the role of inspiration in medical student education
2. Considered their roles and areas of strengths
3. Heard several examples of inspirational work

Elizabeth (Betsy) Garrett, MD, MSPH, is the William C. Allen Professor of clinical family medicine in the Department of Family and Community Medicine at the University of Missouri-Columbia. She is the director of medical student education for the department and directs the 8-week family medicine clerkship and the required ambulatory clinical experience (ACE) for first- and second-year medical students. She was raised and educated in Monett, Missouri, a town of 4,500, before attending the University of Missouri-Columbia where she received her Bachelor of General Studies degree, her MD degree, and completed her family medicine residency. She spent a year as an emergency room physician followed by 3 years practice and teaching in rural New Hampshire as a clinical faculty member in the Department of Community and Family Medicine at Dartmouth Medical School. She then returned to Columbia and completed a Robert Wood Johnson Fellowship. She has a continuity practice of greater than 25 years and regularly teaches students. She is a past president of STFM, past president of the Missouri Academy of Family Physicians, and past chair of the American Board of Family Medicine.

9:45–10:15 am Poster Presentations

See descriptions on pages 29-32.

Room: Tennessee Lobby

Refreshment Break with Conference Partners

Room: Tennessee Lobby

10:30 am–Noon Seminars

S1: Power of Politics and Change

Gretchen Dickson, MD, MBA, University of Kansas School of Medicine-Wichita, Tom Vansaghi, PhD, Society of Teachers of Family Medicine, Leawood, KS

Room: Ryman Studio D

S2: Teaching One-On-One: Going Beyond the Apprenticeship Model

Julie Schirmer, MSW, Maine Medical Center, Portland, ME; Peggy Cyr, MD, Maine Medical Center South, Portland, ME; Carol Rodgers, EdD, Department of Educational Theory and Practice, University of Albany, Albany, NY

Room: Ryman Studio E

S3: How to Develop and Use a Mentored, Reflective Writing E-portfolio for Medical Students

Deborah Jones, MD, MPH, Hetty Cunningham, MD, MPH, Julie Glickstein, MD, Columbia University, New York, NY

Room: Ryman Studio N

S4: STFM's National Clerkship Curriculum: What's New? How Are Clerkships Implementing?

Susan Cochella, MD, MPH, University of Utah, Salt Lake City, UT; Jason Chao, MD, MS, Case Western Reserve University/University Hospitals Case Medical Center, Cleveland, OH; Carol Hustedde, PhD, University of Kentucky; Juliann Binienda, PhD, Wayne State University; Joel Heidelbaugh, MD, University of Michigan; George Harris, MD, MS, University of Missouri-Kansas City

Room: Ryman Studio G

Lecture-Discussions

L1A: Resident-Led Curriculum Reform: Letting Residents Help You Improve Your Clerkship

Rose Zwerenz, MD, Drew Glover, MD, University of Missouri-Kansas City

L1B: The Use of Narrative in a Patient-Centered Medicine Curriculum: Promoting Humanism and Reflective Practice

Memoona Hasnain, MD, MHPE, PhD, Richard Stringham, MD, University of Illinois at Chicago

Room: Ryman Studio P

L2A: Interprofessional Education (IPE): Best Practices and Pathways to Success

Desiree Lie, MD, MSED, University of Southern California, Los Alamitos, CA; Anne Walsh, PA-C, Janet Trial, EDD, MSN, MMSc, Kathy Besinque, PharmD, University of Southern California, Los Angeles, CA; Kevin Lohenry, PhD, PA-C, University of Southern California, Alhambra, CA; Melissa Durham, Pharm D, Keck School of Pharmacy, Los Angeles, CA; Christopher Forest, PA-C, Physician Assistant Program, Alhambra, CA

L2B: A Roadmap for Aligning IPE With Practice Redesign: Lessons From the Health Mentor Program

Lauren Collins, MD, Sokha Koeuth, MPH, Claire Sokas, MSII, Thomas Jefferson University, Philadelphia, PA

Room: Ryman Studio Q

L3A: Pssst! A Pipeline, Shadowing, Simulation, and Students as Teachers Program: Doc4aDay!

Victoria Hayes, MD, Cumberland, ME; Caitlin Willard, MD, Maine Medical Center, Portland, ME

L3B: The Secret Sauce: A Comprehensive Approach to Increase Student Interest in Family Medicine

Wayne Altman, MD, Tufts University, Boston, MA; Amy Lee, MD, Tufts University, Westford, MA; Peggy Cyr, MD, Maine Medical Center, South Portland, ME; Julie Schirmer, MSW, Maine Medical Center, Portland, ME; Stephanie Silverman, MD, Baystate Medical Center, Boston, MA; Vicki Hayes, MD, Tufts University, Boston, MA

Room: Ryman Studio B-C

L4A: Strategies for Teaching Students to Efficiently and Effectively Use an Electronic Health Record (EHR)

James Tysinger, PhD, Kaparaboyana Kumar, MD, FRCS, FAAFP, Nehman Andry, MD, Regina Martinez, MS, University of Texas Health Science Center at San Antonio; Frances Biagioli, MD, Ryan Palmer, EdD, Oregon Health & Science University, Portland, OR

L4B: Seeing the Forest and the Trees: Congruent Therapeutics Curriculum Development for a Family Medicine Clerkship

Joseph Hobbs, MD, Denise Hodo, MPH, David Kriegel, MD, Richard Shurling III, BA, George Nixon, MD, Allen Pelletier, MD, Rosalind Harrington, MD, MSCR, Georgia Regents University, Augusta, GA

Room: Ryman Studio J-K

STFM and Conference Presenters Want Your Feedback!

Please be sure to evaluate each of the educational sessions that you attend at:

stfm.org/sessionevaluation

Also, be sure to complete the Conference Overall Evaluation before you leave the conference, or on your way home, at:

stfm.org/evaluation

10:30 am–Noon Lecture-Discussions (cont.)

L5A: The Dean's Letter: Inspiring Faculty and Students to Contribute in a Meaningful Fashion

Andrea Manyon, MD, SUNY at Buffalo, East Amherst, NY; Kathryn Trayes, MD, Thomas Jefferson University, Philadelphia, PA; Sonia Garcia Laumbach, MD, Rutgers Robert Wood Johnson Medical School, Piscataway, NJ; John Freedy, MD, PhD, Trident Medical Center/ Medical University of South Carolina; Mark Knudson, MD, MSPH, Wake Forest University, Winston-Salem, NC; Richard Holloway, PhD, Medical College of Wisconsin; Kathryn Horn, MD, Texas Tech University, El Paso, TX; David Henderson, MD, University of Connecticut, Farmington, CT; Michael Kavan, PhD, Creighton University Medical Center, Omaha, NE

L5B: Facing Students' Professionalism Problems: Strategies for Feedback and Reflection

Robin DeMuth, MD, Julie Phillips, MD, MPH, Michigan State University, East Lansing, MI; Carol Hustedde, PhD, University of Kentucky, Lexington, KY; Gretchen Dickson, MD, MBA, University of Kansas School of Medicine-Wichita

Room: Ryman Studio L

L6A: What Just One Patient Can Teach—A Longitudinal Patient-Centered Continuity Curriculum

Christine Henrichs, MD, University of Illinois-Urbana, Mahomet, IL; Alexander Slade, M3, University of Illinois-Urbana, Savoy, IL

L6B: Insisting on Continuity: A Student-Led Patient-Centered Third-Year Experience

Kristen Goodell, MD, Camila Cribb Fabersunne, BS, Shekinah Elmore, MPH, Harvard Medical School, Boston, MA

Room: Ryman Studio O

L7A: How to Make Your FM Clerkship Orientation Active and Engaging

Suzanne Minor, MD, Irmanie Eliacin, MD, Ebony Whisenant, MD, Marquita Samuels, BA, Florida International University, Miami, FL

L7B: The Role Clerkship Coordinators Can Play in Curriculum Development and Implementation [COORD]

Maria Cotera, MA, Maryann Dennis, BA, Texas Tech University Health Sciences Center, Paul L Foster School of Medicine, El Paso, TX

Room: Ryman Studio M

Symposia

SY1: Making Your Interprofessional Educational Program Truly Interprofessional

William Hay, MD, UNMC-Family Medicine, Omaha, NE; Javier Sevilla, MD, Indiana University; Lanita White, PharmD, University of Arkansas Medical Science-Little Rock, AR; Jacob Smith, BS, University of Arkansas Medical Science, Hackett, AR

Room: Ryman Studio I

SY2: Equip Students for Musculoskeletal Evaluation by Including a Hands-on Musculoskeletal Workshop Early in Your Curriculum

Toney Welborn, MD, MPH, MS, Mack Green, MD, Oklahoma State University, Oklahoma City, OK; Brian Coleman, MD, University of Oklahoma Health Sciences Center, Oklahoma City, OK; Jason Deck, MD, University of Oklahoma Health Sciences Center, Tulsa, OK

Room: Ryman Studio H

SY3: PCMH Your Own Way: Two Schools, Two Curricula

Martha Seagrave, PA-C, Candace Fraser, MD, University of Vermont, Burlington, VT; Shou Ling Leong, MD, David Richard, MD, Samuel Faber, MD, Carina Brown, Penn State Milton S. Hershey Medical Center, Hershey, PA

Room: Ryman Studio F

12:15–1:30 pm Networking and Student Scholar Recognition Luncheon

Room: Tennessee Ballroom C-E

See list of Student Scholars on page 5.

1:45 – 3:15 pm



Seminars

S5: Going Micro: Using Social Media to Improve Student Engagement and Performance

Adam Saperstein, MD, Stacey McClintick, BS, Ethan Bernstein, MPH, Uniformed Services University, Bethesda, MD

Room: Ryman Studio D

S6: Teaching and Evaluating Motivational Interviewing to Medical Students

Vince WinklerPrins, MD, Alice Lee, BS, Georgetown University, Washington, DC

Room: Ryman Studio B-C

S7: Can We Do a Better Job of Teaching Auscultation Skills, Using Hybrid Simulation?

Paul Lecat, MD, Akron General Medical Center/NEOMED, Tallmadge, OH

Room: Ryman Studio E

S8: Giving Effective Feedback: Making a Better Sandwich

Khalid Jaboori, MD, Sameer Khatri, MD, MAMC Family Medicine Residency Program, Tacoma, WA

Room: Ryman Studio N

S9: Teaching With Emotional Intelligence

Margot Savoy, MD, MPH, CPE, Christiana Care Health Services, Wilmington, DE; Pete Yunyongying, MD, University of Texas Southwestern Medical School, Dallas, TX

Room: Ryman Studio P

Lecture-Discussions

L8A: Leading Change Curriculum

Gretchen Dickson, MD, MBA, University of Kansas School of Medicine-Wichita

L8B: Teaching Medical Students to Choose Wisely

Ashley Bentley, MBA, Stanley Kozakowski, MD, American Academy of Family Physicians, Leawood, KS

Room: Ryman Studio Q

L9A: Acute Presentations Workshop: Using Simulation to Teach “High Stakes” Clinical Situations in a Safe Environment

Miriam Hoffman, MD, Molly Cohen-Osher, MD, Anna Jack, BA, Boston University Medical Center

L9B: Large-Group High-Fidelity Simulation: An Opportunity to Integrate Basic Science and Patient-Centered Care

Mark Beard, MD, Dena Higbee, BS, University of Missouri-Columbia

Room: Ryman Studio J-K

L10A: LGBT Medical Student Experiences in Training: Barriers and Solutions to Being “Out” in Medicine

Matthew Mansh, BS, Stanford University, Menlo Park, CA

L10B: Learning to Teach LGBT (and Especially T) Health From and to Medical Students

Marcia Tanur, MD, Boston University Medical Center, Cambridge, MA; Sarah Houssayni, MD, University of Kansas-Wichita/Via Christi Hospitals, Wichita, KS

Room: Ryman Studio O

L11A: Providing Quality Student Feedback in the Clinical Setting Using Ipad/Facetime: A Multidisciplinary Approach

Carrie Roseamelia, MA, SUNY Upstate Medical University, Syracuse, NY; Carol Recker-Hughes, PT, PhD, MA, College of Health Professions, Syracuse, NY; Ann Botash, MD, College of Medicine, Syracuse, NY; Patricia Powers, DNP, College of Nursing, Syracuse, NY

L11B: iPads, IBooks, Apps! What’s All the Ifuss About?

Lauren Collins, MD, Martha Ankeny, MEd, Kathryn Shaffer, RN, Sokha Koeuth, MPH, Thomas Jefferson University, Philadelphia, PA

Room: Ryman Studio M

L12A: Teaching the Soft Stuff: Using Social Media to Teach Professionalism and Integrative Medicine

Rose Zwerenz, MD, Miranda Huffman, MD, University of Missouri-Kansas City; Angela Barnett, MD, UMKC c/o TMC Lakewood, Lees Summit, MO

L12B: How to Use Text Messaging to Teach

Miranda Huffman, MD, University of Missouri-Kansas City; Hillary Mount, MD, Cincinnati, OH; Gary Rivard, DO, Turner, ME; Stephanie Benson, MD, Southern New Mexico Family Medicine Residency; Rex Dancel, MD, University of North Carolina-Piedmont Health, Prospect Hill, NC; Brandy Deffenbacher, MD, Denver, CO; Kara Gallagher, MD, Carolinas Medical Center (Northeast-Cabarrus), Columbia, SC; Magdalena Michael, MD, Mountain Area Health Education Center Rural, Hendersonville, NC; Jonathan Jackson, MD, Mike O’Callaghan, Federal Medical Center/Nellis Air Force Base, Las Vegas, NV; Benjamin Skinker, MD, UPMC Medical Education (Presbyterian Shadyside Hospital), Pittsburgh, PA; Anthony Viera, MD, MPH, Todd Zakrajsek, PhD, University of North Carolina; Francis Buckman, MD, Brody School of Medicine at East Carolina University, Greenville, NC

Room: Ryman Studio I

L13A: Just Tell Me What I Need to Know: An Orientation Framework for the New Academic Coordinator [COORD]

Christie Legler, ACUME, University of Wisconsin; Morgan Rabatine Nagel, BA, Bellin Health, Green Bay, WI

L13B: Tips and Tricks of the Trade—Problem Solving Skills of an Academic Coordinator [COORD]

Regina Martinez, MS, University of Texas Health Science Center at San Antonio; Christie Legler, ACUME, University of Wisconsin

Room: Ryman Studio L

1:45 – 3:15 pm**Peer Papers:
In-Progress****Pre-Clinical Influence and
Innovations (SESSION A)****PA1: Family Medicine****Preceptorships for First-Year
Medical Students: Looking
Back While Moving Forward**Emily Onello, MD, James Boulger, PhD,
University of Minnesota-Duluth**PA2: MD Year 2 Integration:****Training Clinicians, Not
Researchers**Meaghan Godwin, PhD, Jennifer Joyce,
MD, Mary Lawhon Triano, MSN, CRNP,
Mario Cornacchione, DO, Commonwealth
Medical College, Scranton, PA**PA3: Doctoring Up the Doctor-
ing Course: Development of a
New Clinical Experience for
Preclinical Students**Betsy Jones, EdD, Fiona Prabhu, MD,
Texas Tech University, Lubbock, TX**PA4: The Role of FM in the
Pre-Clerkship MD Curriculum:
A Needs Assessment**Lana Fehr, BSc, BEd, Candice Coley,
BSc; David Keegan, MD, CCFP(EM) FCFP,
Maria Palacios, DDS, PhD, University of
Calgary, Carseland, Alberta**PA5: Making Change Happen:
Increasing the Percentage of
Students Choosing Family
Medicine as a Career**David Keegan, MD, CCFP(EM), FCFP,
Bruce Wright, MD, CCFP, FRCP, Wayne
Woloschuk, PhD, University of Calgary,
Calgary, Alberta**Room: Ryman Studio H****Transforming Clerkships
(SESSION B)****PB1: Regional Collaborations: A
New Model of Rural Training**Carol Hustedde, PhD, William Elder, PhD,
Callie Dowdy, BS, Andrew Johannemann,
BS, Richard Couch, MD, University of
Kentucky, Lexington, KY**PB2: The Good, the Bad, and
the Ugly: Lessons From the
Transformation to a
Longitudinal Clerkship**Howard Sussman, MD, SUNY at Stony
Brook, Stony Brook, NY; Francis Faustino,
MD, SUNY at Stony Brook, Carle Place,
NY**PB3: Implementing a
Longitudinal Health Disparities
Curriculum, Year One
Reflections of Student and
Community Partner
Perspectives**Roger Zoorob, MD, MPH, Ruth Stewart,
MD, Charlotte Woods, MPH, Carmen
Jones, MEd, Meharry Medical
College, Nashville, TN**PB4: Teaching Literature and
Medicine: Experiences
Implementing a Fourth-Year
Distance Learning Elective**Suzanne Harrison, MD, Tana Welch, PhD,
Florida State University, Tallahassee, FL;
Heather Staples, MD, Palmetto Health/
University of South Carolina, Columbia, SC;
Janine Edwards, PhD, Medical
Humanities (Retired), Tallahassee, FL**PB5: Checking In: An Approach
to Assessing a New Family
Medicine Clerkship**Suzanne Lester, MD, MS, UGA, Athens,
GA; Terrence Steyer, MD, Barbara
Schuster, MD, Jeanette Bowman, MPA,
Georgia Regents University, Athens, GA**Room: Ryman Studio F****Peer Papers:
Completed Projects****Improving Communication
(SESSION C)****PC1: Teaching Electronic
Patient Communication Skills**Robert Ellis, MD, Barbara Tobias, MD,
Mandi Sehgal, MD, Gregg Warshaw, MD,
University of Cincinnati, Cincinnati, OH**PC2: “What We’ve Got Is
Failure to Communicate:”****Physical Exam Presentation in
a Second-Year OSCE**Allen Pelletier, MD, Christie Palladino, MD,
Georgia Regents University, Augusta, GA;
Deborah Richardson, PhD, Educational
Innovation Institute at Georgia Regents
University, Augusta, GA**PC3: Student Reflections on
the Interplay Between Chronic
Illness, Function, and Quality
of Life**Christine Jerpbak, MD, Thomas
Jefferson University, Philadelphia, PA;
Ashley Panichelli, MS 3, Jefferson Center
for Interprofessional Education,
Philadelphia, PA; Nethra Ankam, MD,
Department of Physical Medicine and
Rehabilitation, Philadelphia, PA**PC4: Patient Advocate
Connection (PACT):****Development and Evaluation of
a Pilot Educational Intervention**William Jordan, MD, MPH, Jennifer Purcell,
PhD, Hannah Rosenblum, MD Candidate,
Kevin O’Laughlin, MD Candidate, Albert
Einstein College of Medicine, Bronx, NY;
Victoria Gorski, MD, Deborah Swiderski,
MD, Montefiore Medical Center, Bronx, NY;
Emma Ruderman, MD Candidate, Bronx,
NY**Room: Ryman Studio G****3:15–3:30 pm****Poster Presentations**

See descriptions on page 29-32.

Room: Tennessee Lobby**Refreshment Break
with Conference
Partners****Room: Tennessee Lobby**

3:30–5 pm Lecture-Discussions

L14B: Introverted Medical Students: Their Challenges and Strengths in Medical Training

Ralph Gillies, PhD, Allen Pelletier, MD, Bernard Davidson, PhD, Georgia Regents University, Augusta, GA

Room: Ryman Studio D

L15A: So a Medical Student Has Claimed Mistreatment: Now What?

Joel Heidelbaugh, MD, University of Michigan, Ypsilanti, MI; David Power, MD, MPH, University of Minnesota Medical School, Minneapolis, MN; Aaron Michelfelder, MD, Loyola University, Maywood, IL

L15B: Controlling Self, Influencing Others: Communication Skills for Turning Conflicts Into Opportunities

Wesley Theurer, DO/MPH, Sterling Brodniak, DO, Madigan Healthcare System, Tacoma, WA

Room: Ryman Studio B-C

L16A: Preparing for International Health Experiences: A New Curriculum and Student Perspectives

Jacob Prunuske, MD, MSPH, Courtney Moors, MS1, Eric McDaniel, MS1, Tom Baron, MS1, Audrey Bennett, MS1, University of Minnesota Medical School, Duluth, MN

L16B: The Global Gamut: Development of a Global Health Pathway for Medical Students

Elizabeth Brown, MD, MPH, Sabrina MacDuff, BS, University of Rochester/Highland Hospital of Rochester, Rochester, NY

Room: Ryman Studio E



L17A: EVOLVE Clinic: Use of a Virtual Patient Panel as a Longitudinal Teaching Strategy

Jane Gudakunst, MD, Osteopathic Medical Specialties, Lansing, MI; Suzanne Wilson, MSN, RN, MSUCOM/Macomb University Center, Clinton Township, MI; Mary Hughes, DO, Michigan State University College of Osteopathic Medicine, East Lansing, MI; Rebecca Pratt, PhD, Michigan State University and CHM, East Lansing MI

L17B: Using Video Clips: Enhance Your Teaching and Make It Stick

Larry Hurtubise, MA, OU-HCOM/Ohio University Heritage College of Osteopathic Medicine FMR, Athens, OH; Sarah Sams, MD, Grant Medical Center (OhioHealth), Columbus, OH; J. Todd Wehl, DO, OU-HCOM/Ohio University Heritage College of Osteopathic Medicine FMR, Grove City, OH; Allison Macerollo, MD, Ohio State University Medical Center, Columbus, OH

Room: Ryman Studio N

L18A: Brain-Friendly Learning: Reducing Cognitive Load to Enhancing Education Outcomes

Shou Ling Leong, MD, Penn State Milton S. Hershey Medical Center, Hershey, PA; David Anthony, MD, MSc, Memorial Hospital of Rhode Island/Brown University, Pawtucket, RI; Jason Chao, MD, MS, Case Western Reserve University/University Hospitals Case Medical Center, Cleveland, OH; Alexander Chessman, MD, University of Florida; Leslie Fall, MD, Bridie Napier, MD, Geisel School of Medicine at Dartmouth, Lebanon, NH; Katherine Margo, MD, University of Pennsylvania; Stephen Scott, MD, MPH, Weill Cornell Medical College, New York, NY; Martha Seagrave, PA-C, University of Vermont, Burlington, VT; John Waits, MD, University of Alabama-Tuscaloosa, Centreville, AL

L18B: Flipping the Classroom: Using Novel Teaching Tools to Maximize Learning Opportunities Within a Transition Clerkship

Katherine Wagner, MD, Ann Rutter, MD, MS, Mara McErlean, MD, Albany Medical Center, Albany, NY

Room: Ryman Studio J-K

3:30–5 pm

**Lecture-Discussions
(cont.)****L19A: Skills Practice and
Formative Peer and Faculty
Feedback: Key Elements for
Learning Patient-Centered
Communication Skills**

Rosanne McBride, PhD, Charles
Christianson, MD, ScM, University of
North Dakota, Grand Forks, ND

**L19B: Translation and
Application of Health Literacy
Concepts by Medical Students**

Tracey Smith, DNP, PHCNS-BC, MS, RN,
Harald Lausen, DO, MA, Hope Cherry, BS,
CHES, Southern Illinois University,
Springfield, IL

Room: Ryman Studio P**Peer Papers:
In-Progress****Physician Preservation and
Public Health (SESSION D)****PD1: Inoculating Against
Burnout: Potential Effects on
Behavior and Wellness in
Medical Students**

Kendalle Cobb, MD, Cleveland Clinic
Lerner College of Medicine of
CWRU, Cleveland, OH; Sideris Facaros,
MBS, Commonwealth Medical
College, Scranton, PA; Lisa Gussak, MD,
University of Massachusetts, Worcester,
MA

**PD2: Addiction: An Intervention
to Influence Medical Students'
Attitudes and Response to
Substance Abuse Within
Professionals**

Mario Cornacchione, DO, Jennifer Joyce,
MD, Mary Lawhon Triano, MSN, CRNP,
Meaghan Godwin, PhD, Commonwealth
Medical College, Scranton, PA

**PD3: Integrating Public Health
Into Medical Student
Education: A New Model for
Academic Health Centers**

Peter Cronholm, MD, MSCE, Giang
Nguyen, MD, MPH, MSCE, Heather
Klusaritz, PhD, Katherine Margo, MD,
University of Pennsylvania, Philadelphia, PA

**PD4: How Valuable Is an
Additional MPH Degree for
Medical Students Planning to
Enter Family Medicine?**

Peter Meyers, BS, Brian Park, BA, Owen
Aftreth, BS, David Power, MD, MPH,
University of Minnesota Medical
School, Minneapolis, MN

**PD5: Advance Care Planning
Interviews With Geriatrics
Trained Patients During
Home Visits**

Mari Egan, MD, MHPE, Sonia Oyola, MD,
Shewanna Wackman, BA, Carly Berg, BA,
University of Chicago/Pritzker, Chicago,
IL; Maurice Scott, MD, Stacie Levine, MD,
Aliza Baron, MA, University of Illinois at
Chicago

Room: Ryman Studio Q

3:30–5 pm

**Peer Papers:
Completed Projects****Innovations in Teaching
(SESSION E)****PE1: Using Observed
Structured Teaching Exercises
(OSTEs) to Enhance Bedside
Physical Examination Teaching
by Senior Students**

Tovi Anderson, PhD, Emory University,
Decatur, GA; Lauren Colbert, BS, Hugh
Stoddard, MEd, PhD, Joyce Doyle, MD,
Emory University, Atlanta, GA; Lisa
Bernstein, MD, Jason Liebbezeit, MD, Daniel
Yoo, BS, Connie Coralli, RN, MN, MPH,
Barbara Pettit, MD, Atlanta, GA

**PE2: An Innovative Educational
RCT to Evaluate Teaching in the
Patient's Presence**

David Power, MD, MPH, Ian Reynolds, BS,
Lindsey Johansen, MD, University of
Minnesota Medical School, Minneapolis,
MN; Marcy Rosenbaum, PhD, University of
Iowa Hospitals and Clinics, Iowa City, IA;
Darin Brink, MD, University of Minnesota
Medical School, St. Paul, MN; Shailendra
Prasad, MD, MPH, University of Minnesota/
North Memorial Hospital, Minneapolis, MN

**PE3: Two Worlds Meet:
Small-Group Learning Nurtures
Medical Student Leadership in
Community-Based
Participatory Research**

Joedrecka Brown, MD, Ivana Simpson, BS,
Florida State University, Tallahassee, FL

**PE4: Implications of Students'
Gender and Ethnicity on Patient
Encounters in a Distributed
Family Medicine Clerkship**

Joseph Hobbs, MD, Denise Hodo, MPH,
George Nixon, MD, David Kriegel, MD,
Stephen Looney, PhD, Georgia Regents
University

Room: Ryman Studio O**Population and Community
Health (SESSION F)****PF1: Reducing Readmissions:
Results of a Quality
Improvement Curriculum for
Rotating PharmD Students**

Nicholas Cohen, MD, Cindy Zanin, MSSA,
LISW-S, Case Western Reserve University
(MetroHealth), Cleveland, OH; Darrell
Hulisz, PharmD, Eric Luan, Clint Snyder,
PhD, James Werner, PhD, MSSA, Case
Western Reserve University/University
Hospitals Case Medical Center, Cleveland,
OH

**PF2: Teaching Population Health:
A Competency Map
Approach to Education**

Nancy Weigle, MD, Joyce Copeland, MD,
Duke University Medical Center, Durham,
NC

**PF3: Asking Questions: Training
Students to Activate Patients as
a Service to Health Centers**

Darwin Deen, MD, Sophie Davis School of
Biomedicine, City College of New York, New
York, NY; Lauren Berliner, BS, SUNY Health
Science Center, Brooklyn, NY

**PF4: Evaluation of an
Interprofessional Geriatric
Clinical Skills Fair**

Lauren Collins, MD, Brooke Salzman, MD,
Danielle Snyderman, MD, Claire Sokas,
MSII, Tracey Vause-Earland, OTR, Leigh
Ann Hewston, DPT, Emily Hajjar, PharmD,
Cecelia Borden, RN, Thomas Jefferson
University, Philadelphia, PA

Room: Ryman Studio M



3:30–5 pm Hot Topic Session

HT1: Designing, Implementing, and Disseminating Educational Research

Alison Dobbie, MD, Ross University School of Medicine; James Tysinger, PhD, University of Texas Health Science Center at San Antonio

Room: Ryman Studio L

3:30–5:30 pm Workshops

W1: Team-Based Learning

Bethany Teer, MD, Darnall Army Medical Center, Lacey, WA; Sameer Khatri, MD, Madigan Healthcare System, Tacoma, WA

Room: Ryman Studio I

W2: How to Write a Case Report: Interactive Workshop

Christopher Bunt, MD, Uniformed Services University, Herndon, VA; James Keck, MD, Anna Oberhofer, MD, Naval Hospital, Jacksonville, FL; Kelly Latimer, MD, Naval Hospital, Pensacola, FL; Paul Patterson, PhD, Uniformed Services University, Bethesda, MD; Robert Lennon, MD, JD, Uniformed Services University, Okinawa

Room: Ryman Studio H

W3: Writing Meaningful Letters of Recommendation for Medical Students in Family Medicine

Christine McFarlin, MD, MPH, Suzanne Minor, MD, David Brown, MD, Marquita Samuels, BA, Florida International University, Miami, FL; Alexandra Piedra, Vanderbilt University, Miami, FL

Room: Ryman Studio F

W4: Using an Innovative Feedback Model to Inspire Learners Toward Self-Directed Learning

Dennis Baker, PhD, Alabama College of Osteopathic Medicine, Tallahassee, FL; Gregory Turner, EdD, Florida State University, Tallahassee, FL; Suzanne Bush, MD, Florida State University, Pensacola, FL

Room: Ryman Studio G

Plan your conference experience, visit www.stfm.org/mse to search educational sessions and to view abstracts for each presentation. This information is also available at www.stfm.org/mobile.

Join the conversation on Twitter #MSE14



STFM and Conference Presenters Want Your Feedback!

Please be sure to evaluate each of the educational sessions that you attend at:

stfm.org/sessionevaluation

Also, be sure to complete the Conference Overall Evaluation before you leave the conference, or on your way home, at:

stfm.org/evaluation

“I love the STFM conference on Medical Student Education! It’s the only conference where I am guaranteed to walk away energized, excited about teaching students, and full of new ideas for next year. I wouldn’t miss it.”

7:30–8:30 am

Special Topic Breakfasts

Room: Tennessee Ballroom C-E

Join your conference colleagues as they share helpful teaching and learning tools, innovations, and experiences in an informal setting over breakfast. Topic discussions will be focused on problem-solving and idea-sharing.

B2: Recruiting and Training Community Faculty at a New Medical School: Successes and Challenges

Charmaine Martin, MD, Gurjeet Shokar, MD, Texas Tech University Health Sciences Center, Paul L. Foster School of Medicine, El Paso, TX; Maria Cotera, BS, Texas Tech University (Amarillo), El Paso, TX

B3: Recruitment and Retention of Rural Preceptors: Old and New Perspectives

James Boulger, PhD, Emily Onello, MD, University of Minnesota Medical School, Duluth, MN

B4: Communicating With Community Clinical Faculty: Balancing Appreciation With Education and Feedback

Richard Stringham, MD, University of Illinois at Chicago

B5: Teaching Learners About Social Determinants of Health Through the Development of Community Resources

Sarah Houssayni, MD, Todd Stevens, MD, University of Kansas, Wichita/Via Christi Hospitals, Wichita, KS; Mary Baker, NP, California State University, Carlsbad, CA; Marcia Tanur, MD, Boston University Medical Center, Cambridge, MA



B6: Two Universities' Experiences With Professionalism Remediation of the Family Medicine Clerkship

Suzanne Minor, MD, Florida International University, Miami, FL; Nancy Baker, MD, Florida State University, Sebastian, FL

B7: Social Media and Medical Education: Challenges, Opportunities, and Pitfalls

Carolyn Lindeman, BA, University of Texas Southwestern Medical School, Dallas, TX

B8: Best Practices for Scheduling Students on the Family Medicine Clerkship or Electives

Mario DeMarco, MD, MPH, University of Pennsylvania, Philadelphia, PA

B9: It Takes a Village: The Role of the Clinical Coordinator in the Family Medicine Clerkship

Nancy Weigle, MD, Joyce Copeland, MD, Jody Crabtree, Duke University Medical Center, Durham, NC

B10: The EMR as an Education Tool: Finding the Diamond in the Rough?

Karly Pippitt, MD, University of Utah, Salt Lake City, UT; David Norris Jr, MD, University of Mississippi Medical Center, Jackson, MS

B11: Using Students' Medical School Admission Essays to Reflect on Career Choice and the Hidden Curriculum

Lisa Gussak, MD, Phillip Fournier, MD, University of Massachusetts, Worcester, MA

B12: Two Heads Are Better Than One: Modeling Interprofessional Practice for the Millennial Student

Denise Hooks-Anderson, MD, Saint Louis University, Richmond Heights, MO; Erica Pearce, PharmD, BCPS, St. Louis College of Pharmacy, St Louis, MO

B13: Metafeedback: Giving Feedback on Preceptors' Written Comments for Medical Educators and Physician Assistant Educators

Kimberly Zoberi, MD, Chezna Warner, PA, Saint Louis University, St Louis, MO

B14: Implementing a Journal Club Curriculum: Administrative Structure, Resource Tools, and Lessons Learned

Lloyd Runser, MD, MPH, Womack Army Medical Center, Fayetteville, NC

B15: Engaging Preceptors With Faculty Development: The Certificate of Training Achievement

Jeffrey Morzinski, PhD, MSW, Tess Chandler, NA, Linda Meurer, MD, MPH, Karen Hulbert, MD, Rebecca Bernstein, MD, Medical College of Wisconsin, Milwaukee, WI

B16: Service-Based Learning: The Value of Students Serving at a Community Clinic

Vivek Kantayya, MD, Lolita Ontiveros, BS, University of Illinois at Rockford; Elizabeth Rios, APN, Community Health Partnership, Chicago, IL

B17: Summer Fellowship in Family Medicine: Two Students' Reflections [COORD]

Leslie Patterson, MS, PhD, Derrick Hall, BS, Michelle Wenzel, BS, Joan Bedinghaus, MD, Karen Hulbert, MD, Douglas Bower, MD, Medical College of Wisconsin, Milwaukee, WI

B18: The Chris Williams Case: A Longitudinal Encounter With a Simulated Patient to Increase Patient-Centered Assessments

Miranda Huffman, MD, Rose Zwerenz, MD, University of Missouri-Kansas City; Angela Barnett, MD, UMKC c/o TMC Lakewood, Lees Summit, MO

B19: Community Faculty: Recruiting and Retaining Preceptors in a Shrinking Pool

Jennifer Burba, BS, Shannon Cooper, BA, Scott Renshaw, MD, Jennifer Custer, BA, Indiana University, Indianapolis, IN

B20: Anytime Learning: Using Self-Directed Online Modules in a Family Medicine Clerkship

Matthew Holley, MA, MS, Shannon Cooper, BA, Ashley Butler, BSN, Jennifer Burba, BS, Scott Renshaw, MD, Jennifer Custer, BA, Deanna Willis, MD, MBA, Indiana University, Indianapolis, IN

B21: Avatar Technology: A Novel Approach to Teaching and Assessment in Medical Student Education

Holly Cronau, MD, Allison Macerollo, MD, Ohio State University Medical Center, Columbus, OH

B22: Finding the Sweet Spot: Student Engagement in the Transformation of Primary Care Delivery

Andrew Morris-Singer, MD, Primary Care Progress, Cambridge, MA; Owen Aftreth, BS, University of Minnesota Medical School, St Paul, MN

B23: The Roles, Responsibilities, and Development of the Clerkship Coordinator [COORD]

Marquita Samuels, BA, Florida International University, Miami, FL

B24: Community, Population, and Public Health: Drawing Strength From Diversity

Jacob Prunuske, MD, MSPH, University of Minnesota Medical School, Duluth, MN; Paul Hunter, MD, University of Wisconsin, Milwaukee, WI

B25: The Ethical Implications of Medical Education Debt for Family Medicine Educators

Julie Phillips, MD, MPH, Michigan State University, East Lansing, MI

B26: Coordinators: Why Recruiting Visiting Medical Students Does Not Need to Be Difficult: Tips and Tricks [COORD]

Peter Cao, BA, University of Minnesota Medical School, Minneapolis, MN



7:30–8:30 am
Special Topic
Breakfasts (cont.)

B27: Teaching Global Health Concepts: An Adaptable Elective

Daniel Van Durme, MD, Joedrecka Brown, MD, Florida State University, Tallahassee, FL

B28: Reigniting the Flame: Ways to Address and Prevent Physician Burnout

Joanne Williams, MD, MPH, Emory University, Atlanta, GA

B29: What Should Community Preceptors Teach? The Tensions Between Integration and Application

Stephen Scott, MD, MPH, Weill Cornell Medical College in Qatar, New York, NY; David Anthony, MD, MSc, Memorial Hospital of Rhode Island/Brown University, Pawtucket, RI; Katherine Margo, MD, University of Pennsylvania, Philadelphia, PA; Jason Chao, MD, MS, Case Western Reserve University/University Hospitals Case Medical Center, Cleveland, OH; Martha Seagrave, PA-C, University of Vermont, Burlington, VT; Alexander Chessman, MD, Medical University of South Carolina, Charleston, SC; Shou Ling Leong, MD, Penn State Milton S. Hershey Medical Center, Hershey, PA

B30: Attracting Medical Students to Primary Care: a Collaboration Between Family Medicine, Internal Medicine, and Pediatrics

Heather Paladine, MD, Maria de Miguel, MD, Susan Cohen, MPH, Dodi Meyer, MD, Anne Armstrong-Coben, MD, Richard Younge, MD, MPH, Nicholas Fiebach, MD, Columbia University, New York, NY

B31: Can We Win With the Fast Track?

Joanne Williams, MD, MPH, Emory University, Atlanta, GA

B32: How to Identify and Prevent Burnout: Becoming Mindful Through Mind-Body Medicine

Sonia Oyola, MD, David Goese, University of Chicago/Pritzker, Chicago, IL

B33: Getting Really Big Buy-In for Your Educational Initiatives

David Keegan, MD, CCFP(EM), FCFP, University of Calgary, Calgary, Alberta; Susan Bannister, MD, FRCPC MED, Paediatrics/Alberta Childrens Hospital, Calgary, Alberta

B34: Longitudinal Training for Careers in Underserved Communities: Where Do We Stand?

Keith Nokes, MD, MPH, Greater Lawrence Family Health Center, Boston, MA; Mark Ryan, MD, Virginia Commonwealth University, Richmond, VA

B35: For Student Attendees: My Life and Budget as a Family Physician/Educator (a Panel Discussion)

Melissa Robinson, MS4, East Tennessee State University

Plan your conference experience, visit www.stfm.org/mse to search educational sessions and to view abstracts for each presentation. This information is also available at www.stfm.org/mobile.

Join the conversation on Twitter #MSE14



8:30–9 am

Saturday Morning Kick-Off: The Future Family Physician

STFM President
John Saultz, MD



Greetings: Beat Steiner, MD, MPH,
STFM Education Committee chair

Student Scholars and Best Posters Recognition

Room: Tennessee Ballroom C-E

9-10 am

Poster Presentations

See descriptions on page 29-32.

Room: Tennessee Lobby

Refreshment Break with Conference Partners

Room: Tennessee Lobby

10 –11:30 am

Seminars

S10: Top Ten Teaching Tips Millennium Students and Coordinators Want to Tell Their Elders

Mari Egan, MD, MHPE, Hannah Wenger, BS, Kimberly Clinite, BS, David Goese, BS, Kate Adkins, BS, Shewanna Wackman, BS, University of Chicago/Pritzker, Chicago, IL; Jessica Portillo, BS, University of Illinois/Advocate Illinois Masonic Medical Center, Chicago, IL; Alicia Frasz, BA, Family Medicine, Arlington Heights, IL; Suzanne Minor, MD, Florida State University, Miami, FL

Room: Ryman Studio L

S11: Forward Feeding and Educational Malpractice: Practicing One, Preventing the Other

Cathleen Morrow, MD, Geisel School of Medicine at Dartmouth, Lebanon, NH; Lisa Gussak, MD, University of Massachusetts, Worcester, MA

Room: Ryman Studio N

S12: Get a Grip: Emotional Intelligence in Medical Education

Scott Grogan, DO, Dwight David Eisenhower Army Medical Center
Evans, GA

Room: Ryman Studio R

Lecture-Discussions

L20A: Faculty Development Evaluation and Use of Formative Methods to Make In-Program Revisions

Jeffrey Morzinski, PhD, MSW, Linda Meurer, MD, MPH, Karen Hulbert, MD, Rebecca Bernstein, MD, Julie Mitchell, MD, Tess Chandler, NA, Medical College of Wisconsin

L20B: Using the OSCE for Summative Assessment and Evaluation of Post-Encounter Note Performance

Pamela Rockwell, DO, Carrie Bernat, MA, MSW, University of Michigan, Ann Arbor, MI

Room: Ryman Ballroom F

L21A: Implementing a Rural Telemedicine OSCE for Remote and On-Campus Clerkship Learners

Ryan Palmer, EdD, Lisa Dodson, MD, Frances Biagioli, MD, Oregon Health & Science University

L21B: Remote and Local: Using Didactic Video Teleconferencing to Support Rural Clerkship Experiences

Robin Maier, MD, MA, Jeannette South-Paul, MD, John Maier, MD, PhD, Andi Saptono, PhD, University of Pittsburgh, Pittsburgh, PA; Patti Zahnhausen, BA, Pittsburgh, PA

Room: Ryman Ballroom E

L22A: Teaching Students Critical Primary Care Team-Building Skills Through Public Narrative

Andrew Morris-Singer, MD, Primary Care Progress, Cambridge, MA; Karly Pippitt, MD, University of Utah

L22B: Getting Past No: Introducing a New Family Medicine Program Into an Established Curriculum

Martha Seagrave, PA-C, Karen Richardson-Nassif, PhD, Mark Kelly, BA, University of Vermont, Burlington, VT

Room: Ryman Studio O

L23A: The Cloud: Innovative and Effective Tool for Patient Care and Education

Nipa Shah, MD, University of Florida

L23B: Because Life Is Open-Book: a Novel “Open Internet” Final Exam That Teaches as It Tests

Deborah Erlich, MD, MMedEd, Tufts University, Brookline, MA; ElyseLaFond, Tufts University, Boston, MA

Room: Ryman Studio M

10–11:30 am
Lecture-Discussions
(cont.)

L24A: Using Lunchtime Site Visits to Recruit, Train, and Retrain New Community Preceptors

Darin Brink, MD, University of Minnesota Medical School, St. Paul, MN; David Power, MD, MPH, University of Minnesota Medical School, Minneapolis, MN

L24B: Teaching Physician: The Resource for Supporting Faculty Development of Community-Based Preceptors

Tom Vansaghi, PhD, Society of Teachers of Family Medicine, Leawood, KS

Room: Ryman Ballroom B

L25A: Student Evaluations: The Essentials for Valid Assessment

Garrett Meyers, MD, Faculty Development Fellowship at Madigan AMC, Tacoma, WA

L25B: Mentoring, Milestones, and Measuring Competency: Tasks With Many Challenges

George Harris, MD, MS, University of Missouri-Kansas City; Gretchen Dickson, MD, MBA, University of Kansas School of Medicine-Wichita

Room: Ryman Studio B-C

L26A: A Reflective Writing Assignment to Enhance Student Understanding of the Patient-Centered Medical Home

Harald Lausen, DO, MA, Tracey Smith, DNP, PHCNS-BC, RN, Southern Illinois University, Springfield, IL

L26B: A Comprehensive PCMH Curriculum: Transforming Medical Student Education

Lauren Collins, MD, Howard Rabinowitz, MD, Fred Markham, MD, Lisa Michaluk, MEd, Thomas Jefferson University, Philadelphia, PA

Room: Ryman Studio P

L27A: A Medical Education Pathway: Training Our Future Faculty

Celeste Song, MD, Barbara Davis, PhD, Anne Nofziger, MD, Elizabeth Naumburg, MD, Colleen Fogarty, MD, University of Rochester/Highland Hospital of Rochester, Rochester, NY

L27B: Fourth Years as Faculty: Curriculum Development and Teaching Roles for Upper-Level Medical Students

Karl Dietrich, MPH, Geisel School of Medicine at Dartmouth, Norwich, VT; Holly Schroeder, MD, Alpert School of Medicine at Brown University, Providence, RI; Cathleen Morrow, MD, Geisel School of Medicine at Dartmouth, Lebanon, NH

Room: Ryman Studio Q

Symposia

SY4: Recruiting and Maintaining Community Faculty: Four Clerkship Coordinators' Experiences [COORD]

Jane Shaw, MS, Memorial Hospital of Rhode Island/Brown University, Pawtucket, RI; Christie Legler, ACUME, University of Wisconsin; Kelly Hookstadt, BA, University of Connecticut, Hartford, CT; Sandi Cragin, BA, Geisel School of Medicine at Dartmouth, Hanover, NH

Room: Ryman Ballroom C

SY5: Utilizing Simulation to Prepare the Next Generation of Physicians and Health Care Providers

Mary Rubino, MD, Eastern Virginia Medical School, Norfolk, VA; Paul Paulman, MD, UNMC-Family Medicine, Omaha, NE; Beth Fox, MD, MPH, East Tennessee State University, Johnson City, TN

Room: Ryman Ballroom D

Hot Topic Session

HT2: How to Increase Student Interest in Family Medicine: The Canadian Success Story

David Keegan, MD, CCFP(EM) FCFP, College of Family Physicians of Canada, Calgary, Alberta

Room: Ryman Ballroom A

11:30 am–1 pm
Open Lunch with Optional STFM Group Meetings (Lunch on your own)

All conference attendees are welcome to participate in these meetings to learn more about STFM activities and how to get involved.

Group on Faculty Development
Room: Ryman Ballroom D

Group on Medical Student Education

Room: Ryman Studio L

Group on Interprofessional Educators in Family Medicine

Room: Ryman Ballroom C

1–2:30 pm
Lecture-Discussions

L28A: Inspiring Future Family Physicians Through Longitudinal Community Projects: Implementation of a Teen Parenting Health Curriculum

Jordan White, MD, MPH, Susanna Magee, MD, MPH, Memorial Hospital of Rhode Island/Brown University, Pawtucket, RI; Camia Dimock, MD, Maine Medical Center, Falmouth, ME; Jessica Heney, MD, Memorial Hospital of Rhode Island/Brown University, Cumberland, RI; Edward Feller, MD, Community Health, Providence, RI; Elizabeth Ochs, BA, Central Falls High School, Providence, RI

L28B: From Training to Practice: Comparing Values and Motivators of Newbies and Veterans in Underserved Communities

Keith Nokes, MD, MPH, Greater Lawrence Family Health Center, Boston, MA; David Evans, MD, Kevin Brown, BA, Benjamin Krasin, BA, Sharon Dobie, MD, MCP, Amanda Kost, MD, University of Washington, Seattle, WA; Suzanne Mitchell, MD, MS, Boston University Medical Center, Boston, MA; Randy Wertheimer, MD, Cambridge Health Alliance, Cambridge, MA

Room: Ryman Ballroom C



L29A: How Valid and Reliable Is the Clerkship Grading Process?

Robert Hatch, MD, MPH, Mitchell Fehlberg, BS, LouAnn Cooper, PhD, University of Florida

L29B: Delivering a Comparable Family Medicine Clerkship Curriculum Across Multiple Community-Based Campuses

Steven Roskos, MD, Julie Phillips, MD, MPH, Kenya Sekoni, MD, Jeffrey Lambert, BA, Michigan State University, East Lansing, MI; Vince WinklerPrins, MD, Georgetown University, Washington, DC

Room: Ryman Ballroom D

L30A: Leading an Interprofessional Geriatric Clinical Skills Fair: A “Train the Trainer” Session

Lauren Collins, MD, Brooke Salzman, MD, Danielle Snyderman, MD, Tracey Vause-Earland, OTR, Cecelia Borden, RN, Emily Hajjar, PharmD, Leigh Ann Hewston, DPT, Claire Sokas, MSII, Sokha Koeuth, MPH, Thomas Jefferson University, Philadelphia, PA

L30B: Creating Collaborative Practices: Implementation of Interprofessional Experiences in a Family Medicine Clerkship

Karen Sando, PharmD, Robert Hatch, MD, MPH, University of Florida, Gainesville, FL

Room: Ryman Studio N

L31A: Family Medicine Accelerated Track (FMAT): Faculty and Student Perspectives on a 3-Year Medical Degree

Betsy Jones, EdD, Texas Tech University, Lubbock, TX; Ronald Cook, DO, MBA, Simon Williams, PhD, Kim Peck, MD, Fiona Prabhu, MD, Franklyn Babb, MD, Jamie Haynes, MD, Lubbock, TX; Mike Ragain, MD, MEd, Steven Berk, MD, Texas Tech University Health Sciences Center Paul L. Foster School of Medicine, Lubbock, TX; Kitten Linton, MD, Jennifer Mitchell, MD, David Edwards, MD, Kelly Klein, MD, Texas Tech University (Amarillo), Lubbock, TX

L31B: An Early M2 Family Medicine Clerkship Experience: A Feasibility Study

Douglas Bower, MD, Leslie Patterson, MS, PhD, Joan Bedinghaus, MD, Karen Hulbert, MD, Isaac Pierre, MD, Jeffrey Morzinski, PhD, MSW, Medical College of Wisconsin, Milwaukee, WI

Room: Ryman Ballroom A

L32A: Reflective Journals as a Rich Source of Scholarship: Experience From the Rural Underserved Opportunities Program

David Evans, MD, Robert Keys, MPH, Laurel Desnick, MD; Julie Lerman, BS, Roger Rosenblatt, MD, MPH, University of Washington

L32B: Rural Tracks in US Schools of Medicine

Mark Deutchman, MD, Maggie Reinsvold, BS, University of Colorado, Aurora, CO; Christopher Morley, PhD, SUNY Upstate Medical University, Syracuse, NY; David Schmitz, MD, Family Medicine Residency of Idaho Rural Program, Boise, ID

Room: Ryman Ballroom E

L33A: The Family Medicine Approach to Prenatal Care: A Tool for Gaining Student Interest

Anya Koutras, MD, University of Vermont, Williston, VT

L14A: Prezi-fied Mentoring: Be Inspired to Mentor and to Be Mentored

Amanda Cuda, MD, US Army, Madigan Army Medical Center, Gig Harbor, WA

Room: Ryman Ballroom B

L34B: The Feedback Loop in Multiple Institutions: Using Data for Preceptors’ Self-Calibration of Student Grades

Robin Maier, MD, MA, University of Pittsburgh, Pittsburgh, PA; Mary Lindholm, MD, University of Massachusetts, Worcester, MA; Ann Rutter, MD, MS, Albany Medical Center, Albany, NY; Stephanie White, DO, College of Osteopathic Medicine of the Pacific, Pomona, CA

L34A: What Happens When We Tell Our Preceptors They Can’t Grade Students?

Kelly Bossenbroek Fedoriw, MD, Beat Steiner, MD, MPH, University of North Carolina

Room: Ryman Ballroom F

1–2:30 pm

**Peer Papers:
In-Progress****Technology and the PCMH
(SESSION G)****PG1: Capturing Student/Patient
Encounters Using an eLogbook**David Kriegel, MD, George Nixon, MD,
Joseph Hobbs, MD, Georgia Regents
University, Augusta, GA**PG2: Developing a Virtual Of-
fice to Demonstrate the Pa-
tient-Centered Medical Home**Allison Macerollo, MD, Holly Cronau, MD,
Douglas Post, PhD, Millisa Rizer, MD,
MPH, Douglas Danforth, PhD, Ohio State
University Medical Center, Columbus, OH**PG3: Student Self-Assessment
of Strengths and Needed
Improvements at the Midpoint
of a Family Medicine Clerkship**William Huang, MD, Elvira Ruiz, Baylor
College of Medicine, Houston, TX**PG4: Using Online****Technologies to Learn Medical
Students' Perceptions of
PCMH Elements in Their
Clerkship Sites**Michele Doucette, PhD, David Gaspar,
MD, Caroline LeClair, DO, University of
Colorado, Aurora, CO**PG5: Chronic Illness****Management in Teams of
Urban Multidisciplinary
Scholars (CIMTUMS)**John Brill, MD, MPH, Aurora Health
Care, Milwaukee, WI; Diane Ames, FNP,
Concordia University Nursing, Glendale,
WI; Bonnie Kwok, MPH, University of
Wisconsin**Room: Ryman Studio R****Feedback and Competency
(SESSION H)****PH1: Teaching Residents to
Give Quality Feedback**Karen Halpert, MD, Kelly Bossenbroek
Fedoriw, MD, University of North Carolina,
Chapel Hill, NC**PH2: "Fam-Cram:" Peer-
Assisted Learning in a Family
Medicine Clerkship**Jeri Reid, MD, Donna Roberts, MD,
Jonathan Feist, Wanda Lowe, Paul Day,
Amelia Nordmann, University of
Louisville, Louisville, KY**PH3: Use of Sentinel Habits
and Field Notes for Formative
Feedback on a Family Medicine
Clerkship**Joan Bedinghaus, MD, Michelle Wenzel,
MS2, Derrick Hall, MS2, Leslie Patterson,
MS, PhD, Douglas Bower, MD, Karen
Hulbert, MD, Medical College of
Wisconsin, Milwaukee, WI**PH4: Writing for Patients and
Participating in Peer Review
During the Family Medicine
Sub-Internship**Patricia Seymour, MD, MS, University of
Massachusetts, Holden, MA**PH5: Determining the Practice
Competency Objectives of
SHARC-FM (the Shared
Canadian Curriculum in
Family Medicine)**David Keegan, MD, CCFP(EM), FCFP,
University of Calgary, Calgary, Alberta;
Anthony Seto, MD, University of
Alberta, Edmonton; Ian Scott, MD, MSc,
University of British Columbia, Vancouver,
BC; Michael Sylvester, MD, CCFP, MEd,
Queen's University, Kingston; Wayne
Weston, MD, Western University London**Room: Ryman Studio O****Standardized Patients
(SESSION I)****PI1: The Interprofessional
Standardized Patient
Encounter: Preparing Medicine,
Nursing, and Pharmacy
Students to Join Forces**Jana Zaudke, MD, Sarah Shrader,
PharmD, Jim Kleoppel, PharmD, Christina
Phillips, DNP, Tony Paolo, PhD, University
of Kansas, Kansas City, KS**PI2: Interdisciplinary
Teaching Within the Family
Medicine Clerkship to Address
Obesity, Substance Abuse, and
Disabilities**Frank Domino, MD, Mary Lindholm, MD,
Robert Baldor, MD, Karen Rayla, BA,
University of Massachusetts,
Worcester, MA**PI3: A Pilot Study of
Standardized Patients in EBM
Instruction for First-Year
Medical Students**Ross MacDonald, PhD, Sa'ad Laws, MLIS,
Ziyad Mahfoud, PhD, Weill Cornell Medical
College in Qatar Doha, Qatar**PI4: Putting the "Family" in
Family Medicine: Using a
Standardized Patient Family
to Teach Health Promotion**Ann Rutter, MD, MS, Katherine Wagner,
MD, Neil Mitnick, DO, Albany Medical
Center, Albany, NY**PI5: Faculty and Standardized
Patient Perceptions of a Team
Feedback Process in a Family
Medicine Clerkship**Mary Rubino, MD, Bruce Britton, MD,
Eastern Virginia Medical School, Norfolk, VA
Room: Ryman Studio B-C**Peer Papers:
Completed Projects****Clinical Niches in Family
Medicine (SESSION J)****PJ1: The Brown Scholars
Program: A Family Medicine-
Pediatrics Collaboration for
Medical Students**Heather Paladine, MD, Columbia
Presbyterian FMRP, New York, NY;
Margaret Krause, MD, Columbia
University, New York, NY**PJ2: Teaching Students Fertility
and Fertility Awareness-Based
Methods of Family Planning in
Two Medical Schools**Marguerite Duane, MD, Megan Janni, MSIII,
Georgetown University, Washington, DC;
Ashley Stone, MSIII, University of Texas
Southwestern Medical School, Dallas, TX**PJ3: Clerkship Training in
Procedural Skills: What, How,
and How Well?**Martina Kelly, MA, MbBCh, CCFP, Lara
Nixon, MD, FCFP, University of
Calgary, Calgary, Alberta; Alexander
Chessman, MD, Medical University of
South Carolina, Charleston, SC; Kelly
Everard, PhD, Saint Louis University, St.
Louis, MO

PJ4: Comparing Family Medicine Clerkship Student Clinical Activities, Role and Comfort Level: 1997-1999 and 2009-2011

Robert Saywell Jr, PhD, MPH, Scott Renshaw, MD, Ashley Butler, BSN, Jennifer Burba, BS, Terrell Zollinger, DrPH, Richard Kiofsky, MD, Deanna Willis, MD, MBA, Indiana University, Indianapolis, IN
Room: Ryman Studio M

Technological Advances in Education (SESSION K)

PK1: R U 4 PC: Texting and Feedback on Primary Care During Medical School

Andrea Wudyka, MD, William Beaumont Hospital, Birmingham, MI; Andrea Wendling, MD, Michigan State University, Charlevoix, MI; Christopher Morley, PhD, SUNY Upstate Medical University, Syracuse, NY; Julie Phillips, MD, MPH, Michigan State University, East Lansing, MI; Diane Levine, MD, Anne Victoria Neale, PhD, MPH, Wayne State University, Detroit, MI

PK2: The Effectiveness of Moving Animation in Medical Education

Kendall Campbell, MD, Travisha Vaughns, MS1, Alexandra Nowakowski, MS, Florida State University, Tallahassee, FL

PK3: A Randomized Crossover Evaluation of Learning Gains and Format Preference for Online Modules

Jacob Prunuske, MD, MSPH, Amy Prunuske, PhD, University of Minnesota Medical School, Duluth, MN

PK4: Development of a Self-Management Documentation Tool: A Student-Driven Quality Improvement Project

Jana Zaudke, MD, Heidi Chumley, MD, Christie Befort, PhD, Adam Thiessen, MD, Stephanie Clark, MD, Gerry Locheke, MD, Brett Schoen, MD, University of Kansas, Kansas City, KS

Room: Ryman Studio P

Community Service (SESSION L)

PL1: The Student-Run Free Clinics as a Safety Net Provider and Its Economic Impact

Wanda Gonsalves, MD, Patty Coker-Bolt, PhD, Medical University of South Carolina, Charleston, SC

PL2: How a Student-Run Free Clinic Improved Interprofessionalism and Clinical Reasoning

Wanda Gonsalves, MD, Medical University of South Carolina, Charleston, SC

PL3: Service-Learning: Are We Meeting Intended Goals for Students and the Community?

Joyce Afran, MD, Susan Giordano, BA, Rutgers Robert Wood Johnson Medical School, Piscataway, NJ

PL4: Practice Predictors of Graduates of a College of Medicine With a Rural Primary Care Mission

Ivy Click, EdD, Reid Blackwelder, MD, Donald Good, EdD, East Tennessee State University, Johnson City, TN

Room: Ryman Studio Q

Hot Topic Session

HT4: Advising Students for Matching to an Family Medicine Residency (Seminar)

Aaron Michelfelder, MD, Loyola University Chicago; Joel Heidelbaugh, MD, University of Michigan

Room: Ryman Studio L

2:30–3 pm

Refreshment Break with Conference Partners

3–4:30 pm

Lecture-Discussions

L35A: Learning and Teaching Evidence-Based Medicine: Asking and Answering a Clinical Question

Christopher Bunt, MD, Department of Family Medicine, Herndon, VA; Kimberly Jarzynka, MD, UNMC- Family Medicine, Omaha, NE

L35B: Evolution of InfoPOEMs in a Clerkship in Family Medicine: Finally Getting It Right!

Steven Keller, PhD, Chantal Brazeau, MD, Rutgers New Jersey Medical School, Newark, NJ

Room: Ryman Studio N

L36A: Can I Tell You a Secret? An Anonymous Exercise to Address Individual Bias and Improve Health Disparities

Amanda Kost, MD, Frederica Overstreet, MD, MPH, David Evans, MD, Sharon Dobie, MD, MCP, University of Washington

L36B: Students Choose Their Favorite Flavors: 16 Elective Opportunities Embedded in the Family Medicine Clerkship

Wayne Altman, MD, Gillian Morris, BA, Tufts University, Boston, MA; Alicia Krol, MD, Tufts University, Medford, MA

Room: Ryman Ballroom E

L37B: Systems-Based Practice Learning in the Era of Affordable Care Act in a Student-Run Free Clinic

Torian Easterling, MD, MPH, Rutgers New Jersey Medical School, Newark, NJ; Chantal Brazeau, MD, Tiffany Shih, BS, Department of Family Medicine, Newark, NJ

L37A: Inspiring Innovation: The Student-Run Clinic as a Forum for Improvement Projects

Kristen Goodell, MD, Anjali Thakkar, BS, Harvard Medical School, Boston, MA; Diana Wohler, BS, Harvard Medical School, Glastonbury, CT

Room: Ryman Studio R

3–4:30 pm**Lecture-Discussions
(cont.)****L38A: If You Build It, They Will
Come: Program Development in
Distributive Predoctoral Models
of Education**

Carol Hustedde, PhD, Department of Family and Community Medicine, Lexington, KY; Andrea Wendling, MD, Michigan State University

**L38B: How to Measure the
Learning Environment**

Martina Kelly, MA, MbBCh, CCFP, Doug Myhre, MD, FCFP, David Keegan, MD, FCFP, University of Calgary, Calgary, Alberta; Deirdre Bennett, MA, MbBCh, University College Cork, Medical Education Unit Cork

Room: Ryman Ballroom D**L39A: MD.iabetes: An
Experiential Curriculum to
Teach Empathetic Care for
Chronic Medical Conditions**

Lisa Dodson, MD, Charles Procknow, BA, Heather Alva, BA, Ryan Palmer, EdD, Oregon Health & Science University

**L39B: Cadaveric Instruction in
an Integrated Curriculum:
Anatomy and Professional
Development**

Patrick Carr, PhD, Charles Christianson, MD, ScM, Rosanne McBride, PhD, University of North Dakota, Grand Forks, ND

Room: Ryman Ballroom B**Peer Papers:
In-Progress****Professionalism and
Leadership (SESSION M)****PM3: Students' Reflections
About Challenging Patients:
How Do They Change as
Students Develop?**

Jordan White, MD, MPH, Paul George, MD, David Anthony, MD, MSc, Hedy Wald, PhD, Memorial Hospital of Rhode Island/Brown University, Pawtucket, RI

**PM1: Promoting
Professionalism: An
Interdisciplinary Longitudinal
Curriculum in Reflective
Practice**

David Richard, MD, Shou Ling Leong, MD, Peter Lewis, MD, Ann Bogdan, MD, George Henning, MD, Paul Haidet, MD, MaryLynn Fecile, MD, PhD, Eileen Moser, MD, Deborah Kees-Folts, MD, Susan Glod, MD, Patricia Gordon, MD, Chengwu Yang, PhD, Chengwu Yang, PhD, Penn State Milton S. Hershey Medical Center, Hershey, PA

**PM2: Interprofessional
Clinical and Communication
Skills Training Through
Simulation**

Jared Ellis, MD, Richard Slama, MS4, Regina Bentley, RN, BS, University of Alabama-Tuscaloosa

**PM4: Primary Care as Cutting
Edge: Creating a Primary Care
Leadership Academy**

Elisabeth Wilson, MD, MPH, University of California-San Francisco, Berkeley, CA; Anna Chodola, MD, University of California-San Francisco

**PM5: Impact of a Service
Learning Experience in the
Family Medicine Clerkship**

Lori Weir, MD, MPH, Sudhir Vaidya, MD, Jesse Roberts, MS, New York Medical College at St Joseph's Medical Center, Valhalla, NY

Room: Ryman Studio B-C**Advancing Your Clerkship
(SESSION N)****PN1: Implementing a
Case-Based Curriculum Into a
Junior Family Medicine
Clerkship to Improve Students'
Learning Experiences**

Roger Zoorob, MD, MPH, Carmen Jones, MEd, Ruth Stewart, MD, Charlotte Woods, MPH, Meharry Medical College, Nashville, TN

**PN3: Bridging Clinical
Reasoning With Information
Mastery: A Novel Approach to
Medical Education**

Todd Felix, MD, Penn State Milton S. Hershey Medical Center, Harnsburg, PA; F. Samuel Faber, MD, David Richard, MD, Lindsay Smith, Penn State Milton S. Hershey Medical Center, Hershey, PA

**PN4: Does Team Learning
Education in a Family Medicine
Clerkship Improve Medical
Student Attitudes Toward
Collaborative Care?**

Bruce Britton, MD, Priyanka Das, MPH, Eastern Virginia Medical School, Norfolk, VA

**PN5: How Students Add Value
to Continuity Community
Clinics**

Kathleen Brooks, MD, University of Minnesota Medical School, Minneapolis, MN; Tom Greer, MD, MPH, University of Washington, Seattle, WA;

Room: Ryman Studio L**STFM and Conference
Presenters Want Your
Feedback!**

Please be sure to evaluate each of the educational sessions that you attend at:

stfm.org/sessionevaluation

Also, be sure to complete the Conference Overall Evaluation before you leave the conference, or on your way home, at:

stfm.org/evaluation



Peer Papers: Completed Projects

Developing the Training Pipeline (SESSION O)

PO3: Plumbing the Pipeline: A State-Wide Assessment of Educational Changes Needed to Support Primary Care Education

Elisabeth Wilson, MD, MPH, Family
Medicine, Berkeley, CA; Edna Prieto, BA,
University of California-San Francisco

PO1: State Patterns in Medical School Expansion, 2000-2010: Variation, Discord, and Policy Priorities

Wendy Biggs, MD, University of
Kansas, Kansas City, KS; Benjamin Adler,
MS2, University of Massachusetts Medical
School, Worcester, MA; Andrew
Bazemore, MD, MPH, Robert Graham
Center, Washington, DC

PO2: Where Will We Send Our Students? Results of the 2013 Multi-Profession Clerkship/ Clinical Training Site Survey

Monica Whatley, Association of American
Medical Colleges, Washington, DC

PO4: Does Length of Residency Impact Medical Student Interest in Family Medicine?

Carlin Man, MD, University of Calgary,
Coquitlam, BC; Juliann Binienda, PhD,
Margit Chadwell, MD, Wayne State
University, Detroit, MI

Room: Ryman Ballroom F

Apprenticeships and Preceptorships (SESSION P)

PP1: Clinical Apprenticeship: Early Clinical Experience in the M1-M2 Years

Karen Hulbert, MD, Medical College of
Wisconsin, Milwaukee, WI

PP2: A Family Medicine/ Medical Education Elective for Medical Students

David Keegan, MD, CCFP(EM), FCFP,
University of Calgary, Calgary, Alberta

PP4: Impact of Early Primary Care Versus Specialty Preceptorships on Student Morale and Interest in Primary Care

Daniel Rubin, MD, Omar Cid, MS2,
Robert Hatch, MD, MPH, University of
Florida, Gainesville, FL

PP3: A New Approach to a Transitional Clerkship for Medical Students

Paul George, MD, Marina MacNamara,
MPH, Julie Taylor, MD, MSc, Memorial
Hospital of Rhode Island/Brown
University, Pawtucket, RI

Room: Ryman Ballroom C

Hot Topic Session

HT3: Students as Teachers: In Medical School and Beyond

David Power, MD, MPH, University of
Minnesota Medical School; Melissa
Robinson, MS4, East Tennessee State
University; Brian Sick, MD, University of
Minnesota Medical School

Room: Ryman Ballroom A

3–5 pm

Workshops

W5: There's an App for That: Smart Device and Online Learning in Medical Student Education

Douglas Maurer, DO, MPH, Madigan
Healthcare System, Tacoma, WA; Elisa
O'Hern, MD, Madigan Healthcare
System, Tacoma, WA

Room: Ryman Studio O

W6: Things I Wish I'd Known: A Skills Workshop for Faculty New to Medical Student Education

David Norris Jr, MD, University of
Mississippi Medical Center, Jackson, MS;
Mario DeMarco, MD, MPH, University of
Pennsylvania; Suzanne Minor, MD, Florida
International University, Miami, FL; Christina
St. Michel, MD, Baylor College of
Medicine, Houston, TX

Room: Ryman Studio M

W7: Tips on TIPP: Teaching in the Patient's Presence

Ellen Tattelman, MD, Montefiore
Medical Center, Bronx, NY; Lisa Lapman,
MD, Lindsey Fuller, BA, Molly FitzGerald,
MPH, Department of Family and Social
Medicine, Bronx, NY; Harini Kumar, MD,
NYMC FM Residency, Hoboken University
Medical Center, Hoboken, NJ

Room: Ryman Studio P

W8: Employing a Prevention Metaphor for Family Medicine Medical Student Advising

Steven Crossman, MD, Judy Gary,
MEd, Family Medicine and Population
Health, Richmond, VA; James Tysinger,
PhD, Kaparaboyana Kumar, MD, FRCS,
Andry Nehman, MD, University of Texas
Health Science Center at San Antonio;
Christopher Woleben, MD, Virginia
Commonwealth University, Richmond, VA;
Marjorie Hermes, MD, Virginia
Commonwealth University Health System
(Falls Church), Fairfax, VA; Carol Tran, BS,
Virginia Commonwealth University,
Centreville, VA

Room: Ryman Studio Q

7:30–8:30 am

STFM and SSRFC Networking Breakfast

Room: Tennessee Ballroom C-E

8:45–9:45 am

Closing General Session: Family Physicians, Volunteering, and Free Clinics: No Such Thing as a Free Lunch

Room: Tennessee Ballroom C-E

Bonzo Reddick, MD, MPH, New Hanover Regional Medical Center, Wilmington, NC



Moderator: Joel Heidelbaugh, MD, conference cochair

Family physicians are uniquely qualified to provide acute and chronic care to patients, while also educating them on the prevention of disease and providing a wide range of medical services. Combine these skills with the ability to care for patients of all ages in both inpatient and outpatient settings, and family doctors are an obvious choice for the care of patients who have limited access to specialists. This makes the specialty of family medicine a natural source for care of the underserved, including the settings of free clinics or medical missions abroad. A successful future of family medicine is contingent upon exposure to the dynamic skill sets of family physicians early in medical education. This can be done without compromising the ability of family physicians to maintain a successful and

highly productive clinical practice; it can also be one of the most rewarding aspects of being a physician.

By the end of the session, the learner will be able to:

1. Identify the unique ways in which the family physician is the ideal provider for health care in a wide variety of settings, including globally/internationally
2. Identify the positive aspects of caring for underserved patients
3. Describe how mentoring learners in clinical practice can actually improve health care delivery without interfering with productivity

Dr Reddick is the director of Medical Student Education at New Hanover Regional Medical Center’s Family Medicine Residency in Wilmington, NC. He graduated from Morehouse College in Atlanta with a degree in biology, and stayed for medical training at Morehouse School of Medicine. He completed his family medicine residency, career development fellowship, and received his Master’s of Public Health at the University of North Carolina at Chapel Hill. He spent 6 years as the faculty advisor for the Honduran Health Alliance, and traveled twice to the Dominican Republic for medical missions. Dr Reddick was fortunate to have the opportunity to volunteer at the Student Health Action Coalition (SHAC) Clinic, the oldest student-run free clinic in the US, during his time at the University of North Carolina. He volunteers at St. Mary’s Clinic, a free clinic that provides primary and urgent care to uninsured patients in the Wilmington, NC area.

**Friday: 9:45–10:15 am
& 3:15–3:30 pm;
Saturday: 9–10 am**

Room: Tennessee Lobby

Visit with leaders in innovative medical student education curriculum development and research, while viewing their projects and work in an informal information exchange. Research posters that evaluate educational interventions are included. Award-winning posters will be recognized on Saturday.

(NOTE: Please remove poster materials by 10:30 am on Saturday.)

P1: Health Policy 101: The Best Medicine for Population Health

Amy Clithero, MBA, Brian Solan, MD, MPH, Karen Armitage, MD, University of New Mexico, Albuquerque, NM

P2: Drinking From the Fire Hose: A Proactive Approach to Avoiding Medical Student Failure

Ebele Achebe, BA, Louise O'Donnell, PhD, David Henzi, EdD, Thomas King, PhD, University of Texas Health Science Center at San Antonio

P3: Comparison of Medical Student Understanding and Recall of Status Asthmaticus: Traditional Lecture Versus Interactive Teaching

Jennifer Mosher, MD, Scott Hagen, Craig Gjerde, PhD, University of Wisconsin; Jennifer Mosher, MD, Pediatric Critical Care, Madison, WI

P5: An Approach to Integrating an LGBT Health Care Curriculum Through the Family Medicine Clerkship

Ann Rutter, MD, MS, Hank Lai, MS 4, Robert Curry, MsEd, Katherine Wagner, MD, Neil Mitnick, DO, Albany Medical Center, Albany, NY

P6: Impact of a 1-Day Intensive Primary Care Experience on Preclinical Students' View of Primary Care

Katherine Miller, MD, Somerville, MA; Diana Wohler, Harvard Medical School, Boston, MA

P7: A Pivotal Battle Won in the War to Establish Congruency in Clerkship Student Clinical Experiences

Mozella Williams, MD, Kathryn Conniff, MD, University of Maryland, Baltimore, MD

P8: Implementing Screening and Brief Intervention in Underserved Teaching Clinics

Heather Snell, MSPH, Nigel Barner, BS, Roger Zoorob, MD, MPH, Meharry Medical College, Nashville, TN

P9: Accessibility to Healthy Choices for Obese Children in Urban and Rural Areas

Meredith Lewis, MSW, LCSW, Marsha Daniell, MD, University of Alabama at Birmingham, Huntsville, AL

P10: Use of YouTube in Clinical and Academic Medicine

Christopher Miles, MD, Carol Hildebrandt, BA, Stephen Davis, MA, Wake Forest University, Winston Salem, NC

P11: Factors Related to Medical Students' Choices of Primary Care Specialties

Denise McGuigan, MEd, Bonnie Vest, PhD, Blake Talbot, Linda Kahn, PhD, MPH, Karen Devlin, AS, Andrew Symons, MD, MS, SUNY at Buffalo, Buffalo, NY

P12: Development and Pilot Implementation of a Longitudinal Objective Structured Clinical Exam (L-OSCE)

Denise McGuigan, MEd, Andrew Symons, MD, MS, Jeanette Figueroa, MD, David Holmes, MD, Geoffrey Allen, AS, Pam Coniglio, AA, Karen Zinnerstrom, PhD, Bonnie Vest, PhD, SUNY at Buffalo, Buffalo, NY

P13: Development and Pilot Implementation of a Half-Day Procedural Workshop in the Family Medicine Clerkship

Pam Coniglio, AA, Lorne Campbell, MD, Andrew Symons, MD, MS, David Holmes, MD, William Sticht, BS, Bonnie Vest, PhD, Blake Tablot, MPH, SUNY at Buffalo, Buffalo, NY

P14: The Effectiveness of a Primary Care Track in Fostering Medical Student Interest in Family Medicine

Michelle Wenzel, BS, Medical College of Wisconsin, Wauwatosa, WI; Leslie Patterson, MS, PhD, Karen Hulbert, MD, Douglas Bower, MD, Medical College of Wisconsin, Milwaukee, WI

P15: Development and Implementation of an Interprofessional Health Care Course: Lessons Learned

Charles Christianson, MD, ScM, University of North Dakota, Grand Forks, ND

P16: The Impact of a Student-Run Free Clinic on Reducing Emergency Department Visits

Nick Kramer, BS, Jaden Harris, MA; Roger Zoorob, MD, MPH, Meharry Medical College, Nashville, TN

P17: Implementing an Immunization Improvement Plan in an Underserved Residency Practice

Roger Zoorob, MD, MPH, Mohammad Sidani, MD, MS, Jaden Harris, MA, Ashley Fields, MD, MPH, Meharry Medical College, Nashville, TN

P18: The Role of Addressing Missed Opportunities in the Patient-Centered Medical Home

Roger Zoorob, MD, MPH, Mohammad Sidani, MD, Jaden Harris, MA, Meharry Medical College, Nashville, TN

P19: A Team-Based Approach to Educate Students to Assess Patients' Health Literacy for Effective Communication

Gail Marion, PA-C, PhD, Stephen Davis, MA, Carol Hildebrandt, BA, Kathryn Altizer, MS, Sonia Crandall, PhD, MS, Wake Forest University, Winston-Salem, NC

P20: Awareness and Treatment of Uncontrolled Hypertension: Quality of Care in a Family Medicine Resident Clinic

Phillip So, MPH, Wayne State University;
Steven Lin, MD, Stanford University,
Stanford, CA

P21: Standardizing Topic Discussions and Promoting Interprofessional Interactions at Seven Geographically Separate Clinical Training Sites

Jonell Hudson, PharmD, BCPS, University of Arkansas for Medical Sciences AHEC (Northwest) Fayetteville, AR; Sherry Myatt, PharmD, University of Arkansas for Medical Sciences AHEC (South Central) Pine Bluff, AR; Eli Vinson, PharmD, University of Arkansas for Medical Sciences AHEC (Magnolia) Rural Program, Magnolia, AR

P22: IPE: Interprofessional Education, Internalizing Powerful Experiences

Mary Lawhon Triano, MSN, CRNP, Mario Cornacchione, MD, Jennifer Joyce, MD, Commonwealth Medical College, Scranton, PA

P23: Interdisciplinary Education for State Agencies: A Case Study in Connecticut

Kathleen Nurena, MD, Dayna Moriello, MD, Stamford Hospital/Columbia University College of Physicians and Surgeons, Stamford, CT

P24: Encouraging Community Engagement Among Medical Students: The Early Clinical Experience Honors Project

Betsy Jones, EdD, Texas Tech University, Lubbock, TX; Simon Williams, PhD, Patti Patterson, MD, MPH, Lara Johnson, MD, Texas Tech University Health Sciences Center, Paul L. Foster School of Medicine, Lubbock, TX

P25: An Interdisciplinary Approach to Integrating Sports Medicine Into a Family Medicine Clerkship

Justin Wright, MD, Arthur Islas, MD, Charmaine Martin, MD, Gurjeet Shokar, MD, Texas Tech University Health Sciences Center, Paul L. Foster School of Medicine, El Paso, TX



P26: Spicing Up Your First- and Second-Year Curriculum: A Recipe for Developing Simulation Cases

Ruth Westra, DO, MPH, Emily Onello, MD, University of Minnesota, Duluth, MN

P27: Does Early Clinical Exposure to Primary Care During Preclinical Years Influence Career Choice of Students?

Karly Pippitt, MD, Maximilian Padilla, MS, Cameron Smyres, MS, University of Utah, Salt Lake City, UT

P28: Barriers and Strategies for Adolescent Sexual Health in a Rural Community

Christine East, BSc, BA, University of Calgary, Calgary, Alberta

P29: Hospital Volunteers as Health Coaches: A Novel Training Program for an FM Residency Training Practice

Nicholas Cohen, MD, Yolanda Flenoury, RN, CNS, Barbara Nalette, CAVS, Case Western Reserve University (MetroHealth), Cleveland, OH; Yuan Cao, BA, Laura Kosik, BSW, Eric Luan, Rachel Martukovich, MA, James Werner, PhD, MSSA, Case Western Reserve University/University Hospitals, Case Medical Center, Cleveland, OH

P30: Curriculum Changes to Increase Research in a Family Medicine Residency Program

Anna Oberhofer, MD, James Keck, MD, Vanessa McNair, MD, MPH, Naval Hospital, Jacksonville, FL; Robert Lennon, MD, JD, Naval Hospital Okinawa, Bush Clinic Okinawa

P31: An Interdisciplinary Approach to Running a Free Clinic With a Focus on Patient Navigation

Tracey Smith, APRN, BC, MS, Southern Illinois University, Springfield, IL; Janice Frueh, PharmD, Southern Illinois University, Carbondale, IL

P32: The Use and Evaluation of Comprehensive Case Presentations for Longitudinal Care During Clerkship Rotations

Melissa Schiskie, DO, Institute for Family Health (Mid-Hudson), Poughkeepsie, NY

P33: Reflection in Doctoring Course Portfolios Using Interprofessional Team as Faculty Mentors

Meaghan Godwin, PhD, Mary Lawhon Triano, MSN, CRNP, Jennifer Joyce, MD, Mario Cornacchione, DO, Commonwealth Medical College, Scranton, PA

P34: Setting the Example: Medical Students' Attitudes and Language Toward Patient Behaviors

Melissa Marotta-Houser, MD, Middlesex Hospital Program, East Hampton, CT; Robert Macauley, MD, University of Vermont, Burlington, VT

P35: The Growing Issue of Health Literacy and One City's Approach to Eradication

Ann Rutter, MD, MS, Karamjit Chela, MS 4, Katherine Wagner, MD, Albany Medical Center, Albany, NY

P36: Launching a Rural Health Track: A Win-Win in Preceptor Recruitment and Student Satisfaction

Amelia Sattler, MD, O'Connor Hospital (San Jose), Menlo Park, CA; Tracy Rydel, MD, Jimmy Chen, MD, Stanford University, Palo Alto, CA; Kathy Sattler, NP, Eureka Family Practice, Eureka, CA

P37: How Will Faculty Development Influence Adoption of a 3-Year Medical School Curriculum?

Jeffrey Morzinski, PhD, MSW, Leslie Patterson, MS, Medical College of Wisconsin, Milwaukee, WI; Carol Ping Tsao, MD, JD, Zablocki VA Medical Center, Milwaukee, WI

P38: Integrating a New Chapter of Primary Care Progress With FMIG: Minimizing Overlap, Maximizing Impact

Owen Afreth, BS, University of Minnesota Medical School, Saint Paul, MN; Brian Park, BA, Peter Meyers, BS, David Power, MD, MPH, University of Minnesota Medical School, Minneapolis, MN

P39: Bridging the Gap From Hospital to Home: Pre-Clerkship Students Help Patients Navigate Health Care System Waters

Julia Jezmir, BA, Stanford University, Menlo Park, CA; Sang-ick Chang, MD, Stanford University, Stanford, CA; Erika Schillinger, MD, Stanford University, Woodside, CA



P40: Satisfaction With a Wellness Learning Community Is Inversely Associated With Depression In Medical Students

Gillian Stephens, MD, MSc, Joanne Salas, MPH, Cynthia Cook, PhD, RN, MSW, Jeffery Scherrer, PhD, Saint Louis University, St Louis, MO

P41: Celebration of Town and Gown Engagement

Joyce Copeland, MD, Nancy Weigle, MD, Duke University Medical Center, Durham, NC

P42: Poverty and Health Care: Introducing Medical Students to the Health Care Challenges Facing Patients Living in Poverty

Job Larson, MS 3, University of Vermont, Winooski, VT

P43: Social Media in Medical Education: A Role for Popular Media in Assessment and Evaluation

Kendrick Davis, PhD, Michael Nduati, MD, University of California-Riverside, Riverside, CA

P44: The Establishment of a Fourth-Year Continuity Clinic Elective

Rick Henriksen, MD, MPP, Jessica Greenwood, MD, MSPH, Saskia Spiess, MD, University of Utah, Salt Lake City, UT

P45: Compassion and the Art of Medicine Series and Elective: Can Compassion Be Taught?

Kenya Steele, MD, Susan Nash, PhD, Baylor College of Medicine, Houston, TX

P46: Educating Future Physicians on the Use of Chronic Disease Registries

Derrick Hall, BS, Jennifer Mackinnon, MD, Joan Bedinghaus, MD, Douglas Bower, MD, Medical College of Wisconsin

P47: Annual Women's Health Training Day: Does It Effectively Enhance Medical Student Confidence in Women's Health?

Julia Shinnick, BA, School of Medicine, Milford, MA; Ashley Martinez, BS, Emory University, Atlanta, GA

P48: Two Models for a Longitudinal Integrated Third Year: One Medical School's Experience

Charles Christianson, MD, ScM, Roger Schauer, MD, University of North Dakota, Grand Forks, ND; Scott Knutson, MD, Trinity Health, Minot, ND

P49: Becoming Doctors: Using Podcast Storytelling to Promote Reflective Practice in Medical Students

Emily Lines, BS, Mountain View, CA; Erika Schillinger, MD, Woodside, CA; Danica Lomeli, MD, UCLA Medical Center, Redwood City, CA

P50: Faculty Development Through International Collaboration

Audrey Paulman, MD, MMM, Kimberly Jarzynka, MD, Jeffrey Harrison, MD, Paul Paulman, MD, University of Nebraska Medical Center, Omaha, NE

P51: Values-Based Practice: A Third-Year Curriculum to Improve Communication Skills and Empathy

Kathryn Dean, MD candidate, Barbara Brooks, MA, University of South Florida, Tampa, FL

P52: Simming It Up STAT: A Valuable Tool for Interactive Instruction and Improved Learner Assessment

Sara Pope, MD, Madigan Army Medical Center, Lewis-McChord, WA; Wesley Theurer, DO/MPH, Madigan Healthcare System, Tacoma, WA

P53: Creative Arts Journals Reveal Our Students' Secrets

Jose Rodriguez, MD, Kendall Campbell, MD, Florida State University, Tallahassee, FL; Julia Fashner, MD, Florida State University, Fort Myers, FL

P54: Needs Assessment of Preclinical Students' Knowledge, Behavior, and Attitudes Toward Care of the Disabled Patient

Candace Pau, MD, Sandra Feaster, RN, MS, MBA, Susan Eller, RN, MSN, David Gaba, MD, Stanford University, Stanford, CA

P55: Longitudinal Community Engagement Curriculum

Elisabeth Wilson, MD, MPH, University of California-San Francisco, Berkeley, CA

P56: MDIs and DPs: Residents Teaching Students Teaching Patients

Joseph Wilson, MD, University of North Carolina, Saxapahaw, NC

P57: Toward Improved Integration of MedU Cases in Medical Student Education

Martha Seagrave, PA-C, University of Vermont, Burlington, VT; Hannah Foote, BA, Chapel Hill, NC

P58: Bulls-Eye: Experiences of Students Pursuing Family Medicine From the STFM "Target Schools"

Erika Schillinger, MD, Stanford University, Woodside, CA; Michelle Cardona, MD, MPH, MedStar Franklin Square Medical Center, Baltimore, MD; James Perlotto, MD, Yale Health Center, North Guilford, CT

P59: Understanding Patient Perspective on Self-Management of Type 2 Diabetes in a Rural Family Medicine Clinic

Martha Seagrave, PA-C, University of Vermont, Burlington, VT; Anisha Patel, BA, University of Vermont, Colchester, VT

P60: Leadership Training Through Quality Improvement Projects

Elisabeth Wilson, MD, MPH, University of California-San Francisco, Berkeley, CA; Anna Loeb, MD, MPH, University of California-San Francisco, San Francisco, CA

P61: The Impact of Student-Run Free Clinics on Professional Development and Medical Education: Medical Student Perspectives

Alison Chiang, MPH, Stanford University, Millbrae, CA; Steven Lin, MD, O'Connor Hospital, San Jose, CA; Erika Schillinger, MD, Stanford University, Woodside, CA

P62: Preparing Medical Students for Self-Directed Learning: Congruence Between Family Medicine Clerkship Students and Faculty Assessment

Jung Kim, BS, Carl Morris, MD, MPH, John Gayman, MD, Group Health Cooperative, Seattle, WA

Plan your conference experience, visit www.stfm.org/mse to search educational sessions and to view abstracts for each presentation. This information is also available at www.stfm.org/mobile.

Join the conversation on Twitter #MSE14



STFM and Conference Presenters Want Your Feedback!

Please be sure to evaluate each of the educational sessions that you attend at:

stfm.org/sessionevaluation

Also, be sure to complete the Conference Overall Evaluation before you leave the conference, or on your way home, at:

stfm.org/evaluation

Hotel and Conference Location

Gaylord Opryland Hotel & Resort
2800 Opryland Drive
Nashville, TN 37214

Phone: 615.889.1000

Recreation Options

The Opryland Hotel amenities include:

- Access to the fitness center at Relache, the Spa at Gaylord Opryland
- Indoor swimming pool located at Relache Spa
- Scheduled shuttle to the Grand Ole Opry House, General Jackson Showboat, Gaylord Springs Golf Links and Opry Mills
- Bottled water (two per room, per day)
- Wireless internet access in each guest room, atrium, restaurant, and lobby
- Online access to the *Wall Street Journal*
- General Jackson Showboat; Grand Ol' Opry; Gaylord Springs Golf Course (additional costs for these services)

Taxi Service

Taxis are available from the airport and are located outside the arrival terminal. Taxi service from the Opryland Resort can be accessed via the resort's Cascades Lobby. For assistance, please dial "0" from guest phone at the hotel. Fares between the airport and the Opryland Resort are \$25.00 base fare. Check fares with each driver before hiring.

Ground Transportation

Gaylord Opryland offers daily roundtrip shuttle service from the Nashville International Airport to the hotel. Look for the Gaylord Opryland Welcome Desk on the lower level of the airport between the two escalators. An agent can assist with your travel needs and ticket purchase, or use the kiosk by the welcome desk. If an agent is not available, you can find the resort shuttle immediately to the left as you exit the front door of the lower level of the airport.

Daily Shuttle Schedule: 5 am–11 pm (departs every 30 minutes)

Daily Express Shuttle Service: 11 am–7 pm (departs every 20 minutes). Based on demand.

Cost: \$35 per person, roundtrip fare (discounted rate for STFM group)

To make your shuttle reservations and/or to purchase your shuttle ticket in advance, call 615.871.6169 or at hotel ext. 6169 or visit www.stfm.org/mseshuttle

Child Care Services

Contact the Opryland Hotel concierge at 615.871.6169 or 16169 in the hotel for a complete list of bonded & licensed in-house services.

Dine-Around Opryland: Friday, January 31

Join your conference friends and colleagues for a fun dining experience on Friday night. A variety of restaurant options are available throughout the Resort property. Sign-up sheets are posted at the conference registration desk. Participants are responsible for meal costs.

"Paying It Forward" STFM Student Scholarship Support

We have heard the feedback! You want to support students. We all recognize that medical students are the future of family medicine. We know that the more we can encourage their attendance at this conference and their participation in STFM activities, the brighter our future will be!

For the second year we are asked STFM members to support the STFM Student Scholarship Award program. This program identifies outstanding medical students who have chosen a career in academic family medicine, and supports their attendance at the STFM Conference on Medical Student Education. The award recipients are publicly recognized at the conference for their achievements. STFM provides \$500 per student, matched by the student's department of family medicine. Last year 32 conference attendees contributed more than \$3,000, allowing STFM to award 11 scholarships for 2014 instead of the typical five! Our goal this year is to raise \$3,500. If you agree that student scholarships are important, please make a contribution to the STFM Foundation at the conference.

Continuing Medical Education

This live activity, 40th Annual STFM Conference on Medical Student Education, with a beginning date of January 30, 2014, has been reviewed and is acceptable for up to 23.5 Prescribed credit(s) by the American Academy of Family Physicians (includes optional, pre-conference activities on Thursday, January 30). Physicians should claim only the credit commensurate with the extent of their participation in the activity.

AAFP Prescribed credit is accepted by the American Medical Association as equivalent to AMA PRA Category 1 Credit™ toward the AMA Physician's Recognition Award. When applying for the AMA PRA, Prescribed credit earned must be reported as Prescribed, not as Category 1. CME activities approved for AAFP credit are recognized by the AOA as equivalent to AOA Category 2 credit.

Photo/Video Permission

We will be taking photos and video throughout this conference. By attending, you give STFM permission to use images taken at the conference in any electronic or printed communications by STFM for any advertising and promotional purposes. You agree to release STFM and their employees, agents, and designees from liability for any violation of any personal or proprietary right you may have in connection with such use.

Thank you

STFM extends a big thank you to the Conference Steering Committee for all of their hard work in coordinating and planning this year's conference. We also thank members of the Group on Medical Student Education and the Education Committee for assisting with submission reviews, and for serving as poster judges at the conference.

Aaron Michelfelder, MD, Conference Chair
Loyola University Chicago

Joel Heidelbaugh, MD, Conference Cochair
University of Michigan

Beat Steiner, MD, MPH, Education Committee Chair
University of North Carolina

Christine Jerpbak, MD, Education Committee
Thomas Jefferson University

Conference Partners

Tennessee Lobby

STFM and the conference steering committee extend their sincere appreciation to the following Conference Partners for their support of this year's conference. Please be sure to visit with our partners during the conference – they will be joining you at social gatherings and in educational sessions, and will be available to talk with you throughout the conference at their display tables in the Tennessee ballroom foyer area.

Department of Family Medicine, University of Calgary
Calgary, AB

Mid Michigan Health
Midland, MI

Pathways.org
Chicago, IL

Point of Care Ultrasound
Indianapolis, IN

Portal of Geriatric Online Education
New York, NY

The Conference on Medical Student Education expresses sincere appreciation to our Tennessee family medicine colleagues for their support of the 2014 conference Fun Run/Walk and Bus Trip to Downtown Nashville.

East Tennessee State University, Department of Family Medicine

Madison Physicians Group

Meharry Family Medicine Residency Program

University of Tennessee Health Sciences Center



Saturday, February 1
8 am–6 pm

Society of Student-Run Free Clinics Conference 2014

Conference Web site: www.stfm.org/SSRFC

SSRFC aims to become a national, collective voice representing student-run free clinics. Our vision is to promote and support the existence of student-run clinics at every health science center. Through our unified strength, we aim to advocate for both resources and health policy that benefit our patients, and to develop a national network to help sustain student-run free clinics. We truly strive to be an interdisciplinary organization and welcome members from all aspects of health care including medical, osteopathic, dental, physical therapy, pharmacy, or any group that has a student-run clinic. All disciplines and levels of health professionals are encouraged to attend including MD, DO, PT, Pharmacy, and Nursing. Visit www.studentrunfreeclinics.org for more information.

Conference sessions will include topics such as Project Funding, Developing Operational Foundations, Starting New Clinics, Expanding Clinic Services, Patient Advocacy, and Interdisciplinary Care.

Registration Fee:

Registration Fee = \$120 (This fee includes the SSRFC conference educational materials, continental breakfast, boxed lunch, and Networking Breakfast and Closing Session on Sunday. This is a separate registration fee/process, and is not included in your registration for the Conference on Medical Student Education.)

Questions? Contact conference staff at the Society for Student Run Free Clinics registration desk.





The STFM National Clerkship Curriculum

A resource for STFM members

Define and develop a more effective third-year clerkship with an online resource based on the STFM National Clerkship Curriculum.

- Core content and competencies
- Learning objectives
- Assessment tools
- Educational strategies
- Role definitions



Go to www.stfm.org and look for the STFM National Clerkship Curriculum under resources.

47th STFM
Annual Spring Conference

May 3–7, 2014 • Grand Hyatt San Antonio, Riverwalk • San Antonio, TX

Register now at
www.stfm.org/annual

Become a Leader in Family Medicine Education



Apply for the STFM Emerging Leaders program



Why apply?

- Advance your career
- Gain hands-on leadership experience
- Network with other leaders
- Become an agent of change and transformation

Application deadline is January 30, 2015



www.stfm.org/EmergingLeaders

Inspire Our Learners - Support a Student Scholar

Help make it possible to provide scholarships for medical students to attend the Conference on Medical Student Education

You can make your contribution during the 2014 conference at the STFM Foundation table.



2015

STFM Conference on **Medical Student Education**

Get Inspired. Get motivated. Get educated. Get connected.

February 5-8, 2015 | Westin Peachtree Plaza | Atlanta, GA

The 2015 Call for Papers will be available
at www.stfm.org/mse in mid-March



Recruit, train, and retain preceptors

Teaching Physician is an online, streamlined training program that answers questions and communicates regularly with preceptors on your behalf. It's a unique perk for both your program and your preceptors.

Purchase a subscription for your preceptors today!



www.teachingphysician.org

TEACHINGPHYSICIAN

Your Information Resource for Precepting

Lined writing area consisting of 26 horizontal lines.

2014 Conference Partner



2014 Conference Partner



Blank lined area for notes.

2014 Conference Partner



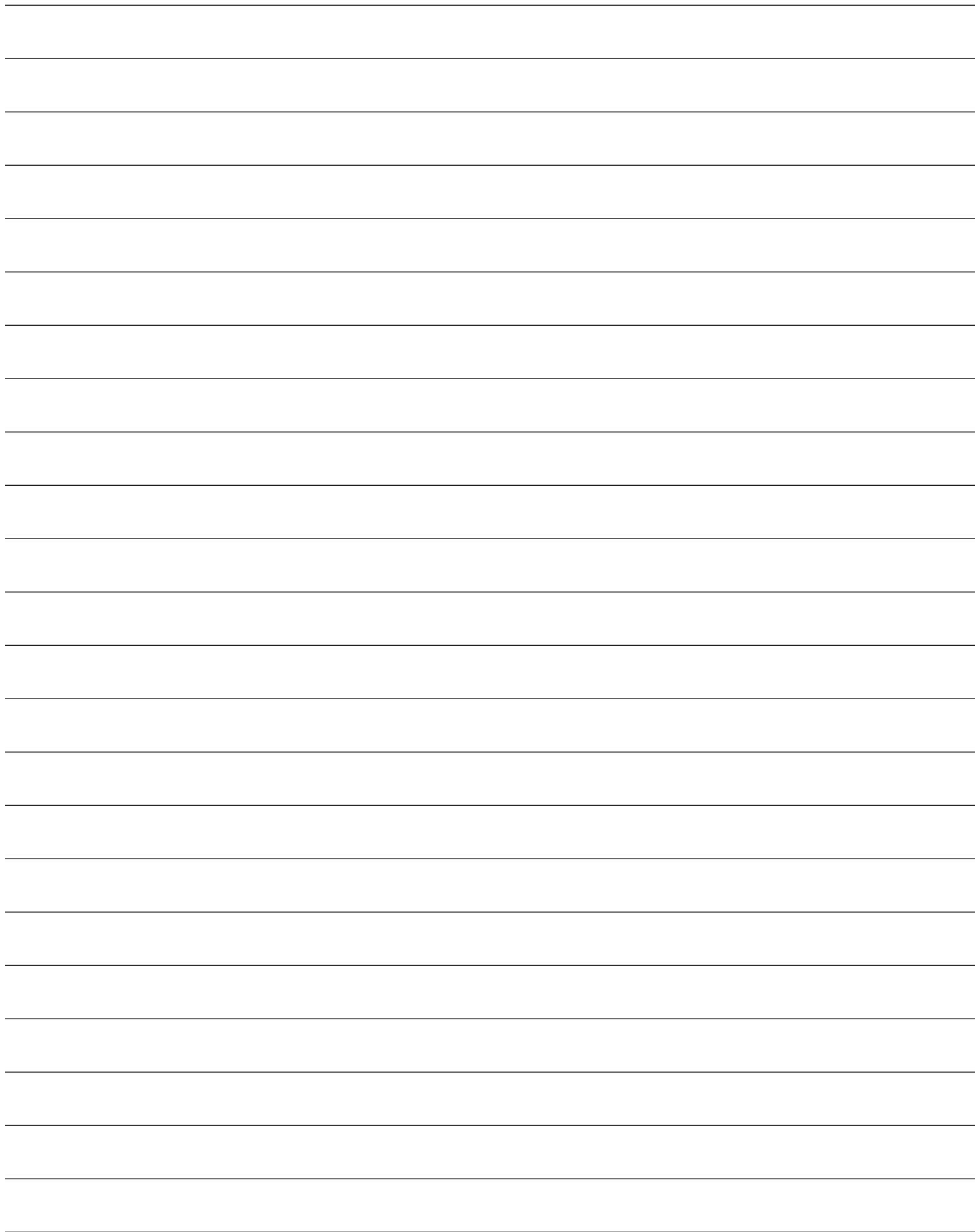

2014 Conference Meeting Space

Tennessee Ballroom
Convention Center | Level 2

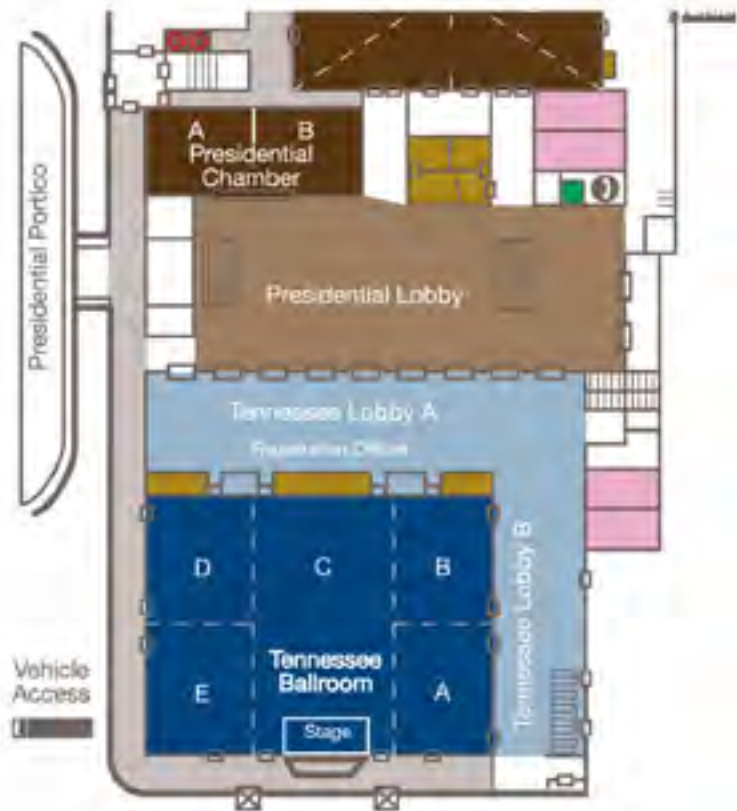

Ryman Ballroom & Studios
Convention Center | Level 0

